



## Epson TM-C3400

### Accurate and Cost-effective Colour Label Printer

- High quality on-demand colour label printing for a variety of applications such as healthcare, retail, manufacturing, logistics, etc.
- Features Epson's renowned Micro-Piezo Inkjet Technology.
- Fast print speeds of up to 92mm per second (56mm print width) in high-speed mode

# TM-C3400

## COLOUR PROTECTS PEOPLE & INVESTMENTS

Human attention is a valuable asset. Does a patient receive the right medication?

Was the correct spare part installed in a machine? Is a visitor authorised to enter the VIP area?

Does an express package make it on board the flight from Sydney to Singapore?

Good or poor legibility of a printed label, especially under time pressure, can have serious consequences.

### Colour highlights your brand & your image

Colour ensures that logos are recognised and re-inforced. In healthcare, logistics, trade, industry and marketing, the Epson TM-colour label printer covers a wide variety of new applications for reliable visual identification using colour.

Use it to print a wide range of formats, materials and surfaces on demand. Would you like to have individual labels or 1,000 labels at once? No problem. Save on the cost of expensive pre-printed stock and produce your colour labels yourself on an as-needed basis.

### Colour is an effective signal & easily understood

Colour is a reliable way of warning about danger. Colour helps you communicate complex content at a glance. Highlight the facts. Set priorities. Differentiate among groups and categories.



## A Printer For A Wide Range Of Applications

### Medical

Colour helps identify patients and medications, highlights important auxiliary information on medical charts.



### Events & Ticketing

Personalised, colourful wristbands are a valuable tool for reliable access control at major events. Customised tickets issued to individuals guard against counterfeits, and colour can be used to create unique and attractive designs.



### Logistics

Coloured dispatch labels help you select from different groups and categories rapidly and reliably.





# GREATER SECURITY FOR DOCTORS AND PATIENTS

Patient wristband:

## Ensure correct allocation by means of a photo

Printed wristbands with barcode, text as well as a photo can be used to identify patients reliably.

Medical controlling:

## Charge costly medications correctly

Colour labels give your staff a clear visual indication from the moment that drugs are dispensed that certain high-priced medications have to be carefully documented.



Injectons and infusions:

## Label your preparations

In operating rooms for example, certain applications require the preparation of injections and infusions a short time in advance. Colour labels that can be printed on demand help your staff declare the contents quickly and conveniently. This method saves time while substantially raising your process quality.



## Industry

Colour facilitates industrial manufacturing processes simply and cost-efficiently. Colour labels help employees in the automotive industry, for example, to identify and assign different components reliably, even under stressful conditions. Sources of error are reduced in this way.

## Retail

Information highlighted in colour on price tags or shelf labels assists with sales promotion in retail business.

## Air travel

In addition to automatic inspection by machines, boarding cards and baggage labels often have to be visually inspected. Colour-coded priorities and personal ID photos, for example, increase security in the identification of baggage and passengers.

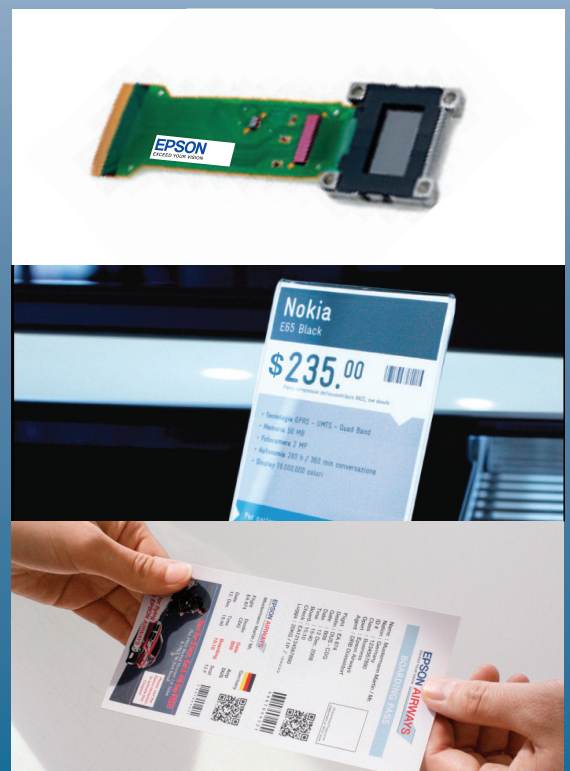



## *PRINT THOUSANDS OF TICKETS EVERY DAY*

Take advantage of the many new possibilities offered by the rapid desktop inkjet label printer. As an event promoter or ticket distributor, your Epson TM-C3400 constitutes your own “in-house print shop”. Reliable, extremely easy to operate and satisfyingly economical.

### Ticketing

#### **Here's how to protect yourself against ticket counterfeiters**

Tickets bear both monetary value and brand imagery. More and more event promoters are personalising their admission tickets, as a preventative measure against the black market and also for a more appealing visual impression.

### Wristbands

#### **Highest security for your major event**

Personalised wristbands are an effective tool for the reliable, fast and cost-effective identification. With the Epson TM-C3400 colour label printer, you can increase the security of conventional ID wristbands through personalisation and colour.



#### **Use colourfully printed wristbands and tickets in a broad range of applications:**

- Trade shows and conferences (exhibition tags)
- Concerts and festivals (wristbands)
- Resorts and amusement parks (IDs)
- Car parks, parking spaces (car park tickets)
- Sporting events (admission tickets)
- TV productions (admission tickets)

# TM-C3400

## EPSON TM-C3400 COLOUR LABEL PRINTER

The major benefits at a glance:

### Cost-effectiveness

You can print 7,500 labels\* with a single ink cartridge. Conventional thermal printers consume ink ribbons as large as a complete label, even if you only print a single line. Inkjet printing is considerably more efficient in this case. Integrated as standard, the auto cutter trims rolls or continuous paper according to your specifications. This means you avoid unnecessary wastage of paper and do not need to store different label sizes and colours.

### Speed

With high print speeds of up to 92mm/sec (printing width: 56mm, 360 x 180 dpi, bi-directional printing) you don't have to keep the customers waiting.

### Versatility

The Epson TM-C3400 colour label printer is a master of versatility. Use it to print a large selection of different formats, materials and surfaces: labels, wristbands, tickets, continuous paper, etc, on media widths 25.4 to 108 mm.

### Permanency

Epson pigment inks ensure excellent permanency compared to thermal printing processes. This system is ideal for labels exposed to sunlight and moisture or for labels used in medical applications.

### Data privacy

Thermal Transfer printers leave printed data as a negative image on the ink ribbon, so used ink ribbons need to be disposed of carefully. This is not an issue with an inkjet printer.

### Convenience

Place the Epson TM-C3400 on a shelf or under a counter to save space. It is the only inkjet label printer with all operating elements positioned on the front face<sup>^</sup>. Consumables can be replaced in the front in a few simple steps. The powerful software and driver support enables you to perform central administration and configuration of large installations with up to 64 printers.

### Environmental protection

Unlike thermal printers or other inkjet technologies, Epson Piezo™ printing technology requires no heating of components. This means energy consumption is minimised. Plus, consistent compliance with the technical standards RoHS (Restriction of Hazardous Substances Directive) and WEEE (Waste Electrical and Electronic Equipment Directive) ensures continued contribution to the protection of our environment.

\* Reference value (print area when printing on plain media with image resolution 360 x 180 dpi: 54mm (W) x 31 (H)).

<sup>^</sup> Except when using fan fold paper, where the paper path is through the rear of the printer.



Economical and flexible. Colour labels on-demand.



Using fan fold paper further extends the range of applications.



Extremely easy replacement of cartridges and paper thanks to front-facing controls allows installation under a counter, for example.

OTHER EPSON  
BUSINESS PRODUCTS



Thermal Receipt Printers



Impact Printers



Hybrid Printers



Disc Publishers



Business Printers



# Epson TM-C3400



## Product Specifications

|                                |   |
|--------------------------------|---|
| <b>Print method</b>            | MicroPiezo® inkjet, 3 colours with pigment ink, Automatic Nozzle Checking technology, composite black   |
| <b>Print Resolution</b>        | 360 dpi x 180 dpi, 360 dpi x 360 dpi, 720 dpi x 360 dpi   |
| <b>Interfaces</b>              | USB or Ethernet   |
| <b>Print font</b>              | Not equipped with print fonts; prints all data as graphic data  |
| <b>Barcodes</b>                | This printer does not have a barcode / two-dimensional symbol encoding function. Following barcode / two-dimensional symbol data (graphic data) are provided by the EPSON Windows driver.<br><b>Barcodes:</b> UPC-A, UPC-E, JAN13(EAN), JAN8(EAN), Code39, ITF, Codabar, Code93, Code128, GS1-128, GS1 DataBar Omnidirectional, GS1 DataBar Omnidirectional, GS1 DataBar Truncated, GS1 DataBar Limited, GS1 DataBar Expanded<br><b>2-dimensional symbols:</b> PDF417, QR Code, Maxi Code, GS1 DataBar Stacked, GS1 DataBar Stacked Omnidirectional, GS1 DataBar Expanded Stacked, Composite Symbology, DataMatrix, Aztec |
| <b>Print speed</b>             | Max. 92 mm / sec. (printing width: 56 mm, 360 dpi x 180 dpi, bi-directional printing)   |
| <b>Paper</b>                   | Supports a wide range of media types such as Plain paper, Fine paper, Continuous paper, Synthetic paper, Die-cut label, PET film, Wristbands, etc.<br><br>Media widths range from 25.4mm to 108mm.<br><br>For full detailed paper specifications please refer to <a href="http://www.epson.com.au">www.epson.com.au</a>   |
| <b>Printing width</b>          | Max. 104 mm   |
| <b>Ink cartridge</b>           | SJIC15P (3-colour combined, pigment ink)  |
| <b>Power consumption</b>       | Operating : Approx. 26 W (100BASE-TX / 10BASE-T)  |
| <b>Reliability</b>             |   |
| <b>MTBF</b>                    | 75,000 hours  |
| <b>MCBF</b>                    | 9.8 million lines   |
| <b>Overall dimensions (mm)</b> | 255 (W) x 270 (D) x 255 (H)   |
| <b>Mass (Approx.)</b>          | 10.0 kg   |
| <b>EMC standards</b>           | VCCI class B, FCC class B, CE marking   |
| <b>Power supply</b>            | Embedded AC adapter   |
| <b>Safety Standards</b>        | UL / CSA / TÜV (EN60950-1)  |
| <b>Operating System</b>        | Microsoft Windows® 2000 SP4, Microsoft Windows® XP SP3, Microsoft Windows® 2003 R2 SP2, Microsoft Windows Vista® SP1 (Only 32 bit Version support)  |



**BSR idware GmbH**  
Jakob-Haringer-Str.3  
A-5020 Salzburg  
Web: [www.bsr.at](http://www.bsr.at)



The TM-C3400 comes with a space-saving integrated PS-180 power supply and is available in a USB and a network version.

**EPSON**  
EXCEED YOUR VISION

## Usage Conditions

Epson products are designed and made to give highly reliable use and long life when used according to its specifications. With any system, product or device used in situations where human life may be involved or at risk, Epson advises that you should take all necessary steps to ensure the suitability of your Epson product for inclusion in your system, and recommends that you include fail-safe procedures and redundancy support or backup equipment in your system, to maintain the maximum safety margin and optimum system reliability.

Epson is the registered trademark of Seiko Epson Corporation. Epson trademarks of Seiko Epson Corporation. All other names and company names used herein are for identification purpose only and may be the trademarks or registered trademarks of their respective owners. Epson disclaims any and all rights in those marks. All print samples shown herein are simulations. Specifications are subject to change without notice.

EPSON AUSTRALIA  
CUSTOMER SERVICE LINE  
**1300 304 POS**  
[www.epson.com.au](http://www.epson.com.au)

EPSON NEW ZEALAND  
CUSTOMER SERVICE  
**0800 443 478**  
[www.epson.co.nz](http://www.epson.co.nz)

**HEAD OFFICE SYDNEY**  
3 Talavera Road  
North Ryde NSW 2113  
Tel: (02) 8899 3666

ABN 91 002 625 783  
03/11