

CT40 CT40 XP RUGGED MOBILE COMPUTER

Configuration Guide

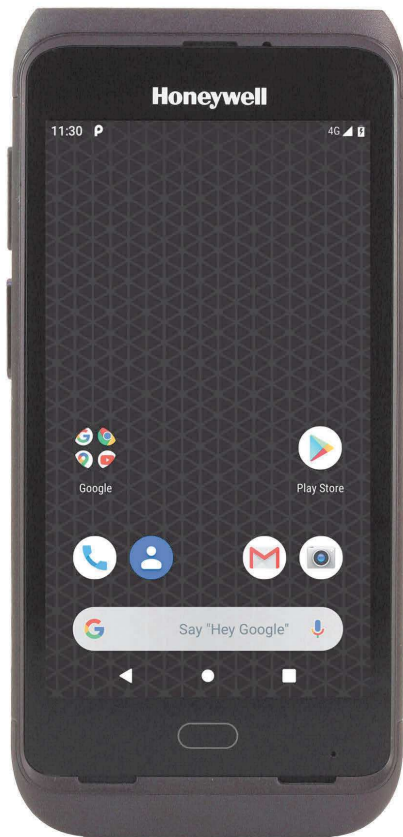

BSR idware GmbH
Jakob-Haringer-Str.3
A-5020 Salzburg
<https://www.bsr.at>
sales@bsr.at



CT40

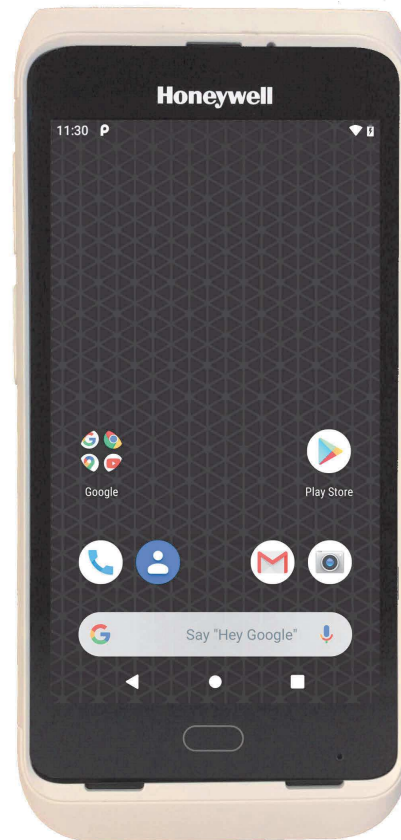

CT40 HEALTHCARE

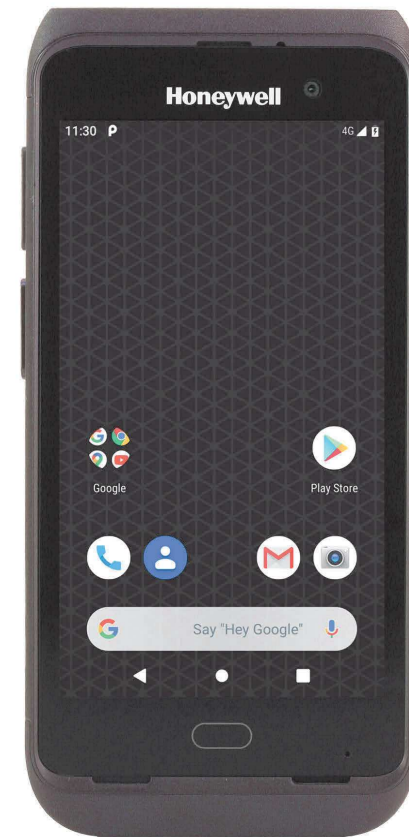

CT40 XP

THE
FUTURE
IS
WHAT
WE
MAKE IT

Honeywell

TABLE OF CONTENTS

| | | | |
|----|--|----|--|
| 2 | CT40 FEATURE OVERVIEW N3601 STANDARD RANGE N6703 STANDARD RANGE DISINFECTANT READY HOUSING - N6703 STANDARD RANGE N6803 FLEXRANGE™ NEAR/ FAR RANGE HEALTHCARE - N6700 GREEN LINEAR LED AIMER - STANDARD RANGE | 23 | CT40 / CT40 XP VEHICLE INSTALL OPTION 1 – PORTABLE/ SUB CONTRACTOR INSTALL OPTION 2 – PORTABLE/ SUB CONTRACTOR INSTALL OPTION 3 - FIXED VEHICLE INSTALL WITH DIRECT CONNECTION TO VEHICLE BATTERY OPTION 4 - FIXED VEHICLE INSTALL WITH DIRECT CONNECTION TO VEHICLE BATTERY/ FUSE BLOCK OPTION 5 - FIXED VEHICLE INSTALL WITH THOR DC/DC CONVERTER CT40 VEHICLE DOCK 360 DEGREE VIEW |
| 6 | CT40 CONFIGURATION MAP | 28 | CT40 / CT40 XP CHARGING AND COMMUNICATION OPTION 1 - NON-BOOTED QUAD CHARGER OPTION 2 - NON-BOOTED QUAD CHARGER WITH UNIVERSAL CUP OPTION 3 - BOOTED QUAD CHARGER OPTION 4 - BOOTED QUAD CHARGER WITH UNIVERSAL CUP OPTION 5 - QUAD BATTERY CHARGER |
| 7 | CT40 XP FEATURE OVERVIEW N6703 STANDARD RANGE N6803 FLEXRANGE™ NEAR/ FAR RANGE DISINFECTANT READY HOUSING - N6703 STANDARD RANGE DISINFECTANT READY HOUSING - N6803 FLEXRANGE™ NEAR/ FAR RANGE HEALTHCARE - N6700 GREEN LINEAR LED AIMER - STANDARD RANGE | 31 | IH21 RFID READER FOR CT40 / CT40 XP |
| 10 | CT40 XP CONFIGURATION MAP | 32 | CT40 HEALTHCARE CHARGING AND COMMUNICATION OPTION 1 - NON-BOOTED QUAD CHARGER WITH UNIVERSAL CUP OPTION 2 - BOOTED QUAD CHARGER WITH UNIVERSAL CUP OPTION 3 - CT40 HC DISPLAY BASE WITH UNIVERSAL CUP |
| 11 | HONEYWELL EDGE SERVICES CT40 / CT40 XP - REPAIR SERVICES COVERAGE | 34 | CT40 / CT40 XP PROTECTIVE BOOT OPTION 1 - RUBBER BOOT OPTION 2 - DOCKABLE PROTECTIVE BOOT |
| 14 | CT40 / CT40 XP SOFTWARE DEVICE CLIENT PACK | 35 | CT40 / CT40 XP HEADSET |
| 15 | CT40 / CT40 XP SCANNING SCAN HANDLE SIDE BY SIDE COMPARISON OPTION 1 - SCAN HANDLE OPTION 2 - SCAN HANDLE WITH PROTECTIVE BOOT OPTION 3 - SCAN HANDLE FOR USE WITH CAMERA | 38 | CT40 / CT40 XP WEARABLE WITH TETHERED RING SCANNER OPTION 1 - CT40 WEARABLE WITH D75E ARM BAND OPTION 2 - CT40 WEARABLE - ARM BAND WRIST PAD |
| 19 | CT40 / CT40 XP DESKTOP COMMUNICATIONS OPTION 1 – PORTABLE - NON-BOOTED OPTION 2 – PORTABLE - NON-BOOTED OR BOOTED OPTION 3 – CT40 XP USB TYPE C ON-THE-GO (OTG) DESKTOP OPTION 4 – CT40 XP USB TYPE C ON-THE-GO (OTG) VEHICLE OPTION 5 – FIXED OPTION 6 – FIXED WITH UNIVERSAL CUP OPTION 7 – DISPLAY BASE OPTION 8 – DISPLAY BASE WITH UNIVERSAL CUP | 39 | MISCELLANEOUS OPTIONAL PARTS MICRO-SD CARDS AC CORDS |

CT40 FEATURE OVERVIEW

N3601 Standard Range

N6703 Standard Range

Included in the box:

- CT40 Mobile Computer
- Battery (318-055-015)
- Hand strap

(Stylus is NOT included, but available to order separately as an accessory)



N6703 Standard Range

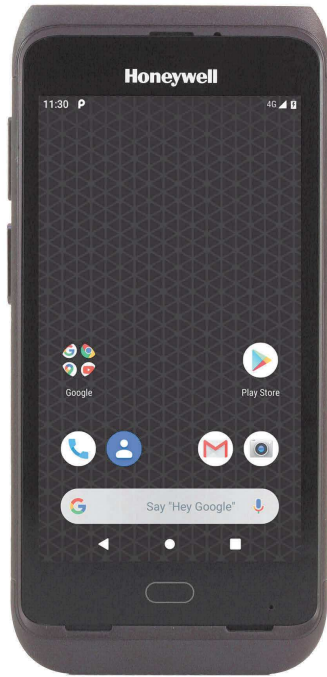

4G LTE / GPS



WiFi / BT



N6703
N3601

Scanner



N3601 Standard Range



3.5mm Audio Jack

(WiFi Models Only CT40-LON-xxxxxAx)

CT40 Android - 4G WWAN - N6703 - 4GB RAM/ 32GB Flash

CT40-L1N-27C11Bx

CT40, Android, WWAN, 802.11 a/b/g/n/ac/r/k/mc, 1D/2D Imager SR (N6703), 4GB/32GB Memory, 13MP Camera, BT 5.0, NFC, Gen 2 Battery 4,040 mAh

CT40 Android - WiFi Only - N6703 - 4GB RAM/ 32GB Flash

CT40-LON-27C11Ax

CT40, Android, WLAN, 802.11 a/b/g/n/ac/r/k/mc, 1D/2D Imager SR (N6703), 4GB/32GB Memory, 13MP Camera, BT 5.0, NFC Gen 2 Battery 4,040 mAh, 3.5mm Audio Jack

(Does not include headset, order CT40-HDST-35MM separately)

CT40 Android - 4G WWAN - N3601 - 2GB RAM/ 32GB Flash

CT40-L1N-1NC11Bx

CT40, Android, WWAN, 802.11 a/b/g/n/ac/r/k/mc, 1D/2D Imager SR (N3601), 2GB/32GB Memory, 13MP Camera, BT 5.0, NFC, Gen 2 Battery 4,040 mAh

CT40 Android - WiFi Only - N3601 - 2GB RAM/ 32GB Flash

CT40-LON-1NC11Ax

CT40, Android, WLAN, 802.11 a/b/g/n/ac/r/k/mc, 1D/2D Imager SR (N3601), 2GB/32GB Memory, 13MP Camera, BT 5.0, NFC, Gen 2 Battery 4,040 mAh, 3.5mm Audio Jack

(Does not include headset, order CT40-HDST-35MM separately)

(Note: x = Domain, select appropriate Domain from Configuration Map on page 6)

Honeywell Repair Services

SVCCT40-SG3N

CT40 / CT40 XP, Edge Service, Gold Maintenance Contract, 3 Year, New Contract

ADD SVCREPLACE-MOB3

AddOn, Edge Service, Device Replacement, Mobility, 3 Year

CT40 FEATURE OVERVIEW

Disinfectant Ready Housing - N6703 Standard Range



Included in the box:

- CT40 Mobile Computer
- Battery (318-055-D67)
- Healthcare Hand strap

(Stylus is NOT included, but available to order separately as an accessory)



No Audio Jack
(WWAN Models CT40-L1N-xxxxxDx)

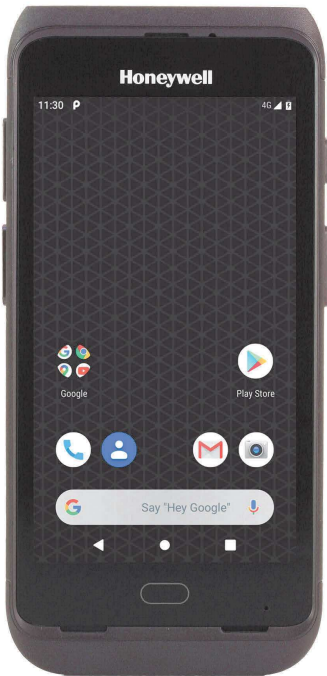

N6703 Standard Range

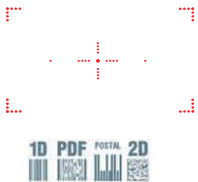

3.5mm Audio Jack
(WiFi Models Only CT40-LON-xxxxxDx)

CT40 Android - 4G WWAN - N6703 - 4GB RAM/ 32GB Flash

CT40-L1N-27C11Dx

CT40 Disinfectant Ready, Android, WWAN, 802.11a/b/g/n/ac/r/k/mc, 1D/2D Imager SR (N6703), 4GB/32GB Memory, 13MP Camera, BT 5.0, NFC, Battery 4,020 mAh Disinfectant Ready Cover, Healthcare hand strap

CT40 Android - WiFi Only - N6703 - 4GB RAM/ 32GB Flash

CT40-LON-27C11Dx

CT40 Disinfectant Ready, Android, WLAN, 802.11a/b/g/n/ac/r/k/mc, 1D/2D Imager SR (N6703), 4GB/32GB Memory, 13MP Camera, BT 5.0, NFC, Battery 4,020 mAh Disinfectant Ready Cover, Healthcare hand strap

(Note: x = Domain, select appropriate Domain from Configuration Map on page 6)

Honeywell Repair Services

SVCCT40-SG3N

CT40 / CT40 XP, Edge Service, Gold Maintenance Contract, 3 Year, New Contract

ADD SVCREPLACE-MOB3

AddOn, Edge Service, Device Replacement, Mobility, 3 Year

CT40 FEATURE OVERVIEW

N6803 FlexRange™ Near/ Far Range

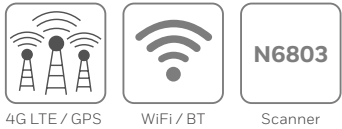

Included in the box:

- CT40 Mobile Computer
- Battery (318-055-015)
- Hand strap

(Stylus is NOT included, but available to order separately as an accessory)



No Audio Jack
(WWAN Models CT40-L1N-xxxxxBx)

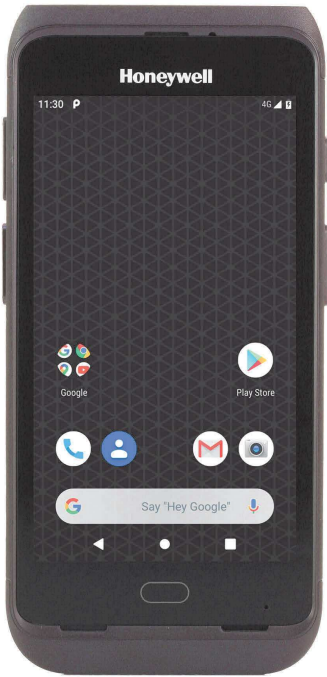

N6803 FlexRange™

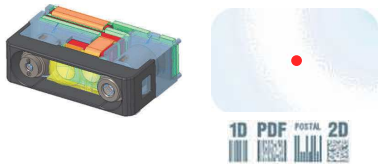

3.5mm Audio Jack
(WiFi Models Only CT40-LON-xxxxxAx)

CT40 Android - 4G WWAN - N6803 FlexRange - 4GB RAM/ 32GB Flash

CT40-L1N-28C11Bx
CT40, Android, WWAN, 802.11 a/b/g/n/ac/r/k/mc, 1D/2D Imager SR (N6803) FlexRange, 4GB/32GB Memory, 13MP Camera, BT 5.0, NFC, Gen 2 Battery 4,040 mAh

CT40 Android - WiFi Only - N6803 FlexRange - 4GB RAM/ 32GB Flash

CT40-LON-28C11Ax
CT40, Android, WLAN, 802.11 a/b/g/n/ac/r/k/mc, 1D/2D Imager SR (N6803) FlexRange, 4GB/32GB Memory, 13MP Camera, BT 5.0, NFC, Battery 4,040 mAh, Metal battery latch button, 3.5mm Audio Jack
(Does not include headset, order CT40-HDST-35MM separately)

(Note: x = Domain, select appropriate Domain from Configuration Map on page 6)

| Honeywell Repair Services | |
|---------------------------|---|
| SVCCT40-SG3N | CT40 / CT40 XP, Edge Service, Gold Maintenance Contract, 3 Year, New Contract |
| ADD SVCREPLACE-MOB3 | AddOn, Edge Service, Device Replacement, Mobility, 3 Year |

CT40 FEATURE OVERVIEW

Healthcare - N6700 Green Linear LED Aimer - Standard Range



4G LTE / GPS



WiFi / BT



N6700
Scanner

- Included in the box:
- CT40 Mobile Computer
 - Battery (318-055-017)
- (Stylus and Hand strap are NOT included, but available to order separately as an accessory)



CT40 Android – WWAN – N6700 – 4GB RAM/ 32GB Flash – Healthcare

CT40-L1N-2LC11Hx CT40, Android, WWAN, 802.11 a/b/g/n/ac/r/k/mc, 1D/2D Imager SR (N6700) with Linear LED Aimer, 4GB/32GB Memory, 13MP Camera, BT 5.0, NFC, Gen 2 Battery 4,020 mAh, White Healthcare without Handstrap.

CT40 Android – WiFi Only – N6700 – 4GB RAM/ 32GB Flash – Healthcare

CT40-LON-2LC11Hx CT40, Android, WLAN, 802.11 a/b/g/n/ac/r/k/mc, 1D/2D Imager SR (N6700) with Linear LED Aimer, 4GB/32GB Memory, 13MP Camera, BT 5.0, NFC, Gen 2 Battery 4,020 mAh, White Healthcare without Handstrap.





(Note: x = Domain, select appropriate Domain from Configuration Map on page 6)

Honeywell Repair Services

| | |
|---------------------|---|
| SVCCT40-SG3N | CT40 / CT40 XP, Edge Service, Gold Maintenance Contract, 3 Year, New Contract |
| ADD SVCREPLACE-MOB3 | AddOn, Edge Service, Device Replacement, Mobility, 3 Year |

CT40 CONFIGURATION MAP

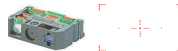
Android

| | | | | | | | | | | | DESCRIPTION | NOTES | | | | |
|-----------------|---|------|-----|--------|---|--------|--------|------------------|---|-------------|-------------|-------|---------|--------|--|---|
| BLUETOOTH/ WIFI | | WWAN | NFC | MEMORY | | IMAGER | CAMERA | OPERATING SYSTEM | | APPLICATION | | | OPTIONS | DOMAIN | | |
| CT40- | | | | | | | | | | | | | | | | |
| L | | | | | | | | | | | | | | | 802.11 a/b/g/n/ac + Bluetooth 5.0 | IEEE 802.11 a/b/g/n/ac/r/k/mc ; Wi-Fi certified V5.0 Bluetooth and BLE Supported Bluetooth Profiles: HFP,PBAP, A2DP, AVRCP, OPP, SPP, GATT |
| | 0 | | | | | | | | | | | | | | No WWAN | |
| 1 | | | | | | | | | | | | | | | LTE (4G) GPS, UMTS/HSPA+ (3G) GSM/GPRS/EDGE | WWAN RADIO (ATT/VZW/SPRINT/TMO/NA/EU) LTE (FDD) – BANDS 1,2,3,4,5,7,8,12,13,17,19,20,25,26,28,29 / LTE (TDD) – BANDS 38,39,40,41 UMTS/HSPA+ (3G) – BANDS 1, 2, 4, 5, 6, 8, 9, 19 / GSM/GPRS/EDGE QUAD-BAND (850/900/1800/1900 MHZ) |
| | | N | | | | | | | | | | | | | Near Field Communications (NFC) | |
| | | | -- | | | | | | | | | | | | | |
| | | | | 1 | | | | | | | | | | | 2GB RAM, 32GB Flash Memory | 2.2 GHz Qualcomm Snapdragon™ 660 octa-core |
| | | | | 2 | | | | | | | | | | | 4GB RAM, 32GB Flash Memory | 2.2 GHz Qualcomm Snapdragon™ 660 octa-core |
| | | | | | L | | | | | | | | | | 1D/2D Imager (N6700) – Standard Range |  |
| | | | | | N | | | | | | | | | | 1D/2D Imager (N360I) – Standard Range |  |
| | | | | | 7 | | | | | | | | | | 1D/2D Imager (N6703SR) – Standard Range |  |
| | | | | | 8 | | | | | | | | | | 1D/2D Imager (N6803FR) – FlexRange™ |  |
| | | | | | | C | | | | | | | | | Camera | 13MP Rear Camera |
| | | | | | | | 1 | | | | | | | | Android (GMS) | Google Mobile Services (GMS) certified – Play Store |
| | | | | | | | 2 | | | | | | | | Android (Non-GMS) | |
| | | | | | | | | 1 | | | | | | | Standard Software Build | |
| | | | | | | | | | 0 | | | | | | Standard | |
| | | | | | | | | | A | | | | | | Audio Jack – New Battery Latch | 3.5mm Audio Jack - supports PTT, VOIP – Only available on WiFi Only models (CT40-LO-xxxxxxx) |
| | | | | | | | | | B | | | | | | No Audio Jack – New Battery Latch | |
| | | | | | | | | | D | | | | | | Disinfectant Ready Housing - Honeywell Grey Colour | Disinfectant Ready Housings (DRHs). DRHs utilize plastics designed to withstand the harshness of frequent cleaning with disinfectants without compromising the lifespan of the equipment. |
| | | | | | | | | | H | | | | | | Healthcare - White | CT40 Healthcare is made from disinfectant-ready materials that are designed to withstand frequent cleaning using approved disinfecting and sanitizing agents. |
| | | | | | | | | | | A | | | | | ANZ & Argentina | Argentina, Australia, New Zealand |
| | | | | | | | | | | E | | | | | WorldWide | Austria, Belgium, Brazil, Bulgaria, Chile, Columbia, Croatia, Cyprus, Czech Republic, Denmark, Dominican Republic, Ecuador, El Salvador, Estonia, Finland, France, Germany, Greece, Hong Kong, Hungary, Iceland, Ireland, Italy, Japan, Latvia, Liechtenstein, Lithuania, Luxembourg, Malta, Netherlands, Norway, Peru, Philippines, Poland, Portugal, Romania, Singapore, Slovakia, Slovenia, South Korea, Spain, Sweden, Switzerland, Thailand, United Kingdom, Venezuela |
| | | | | | | | | | | F | | | | | FCC | USA, Canada, Guatemala, Mexico, Panama, Puerto Rico, Taiwan |
| | | | | | | | | | | M | | | | | Miscellaneous 2.4GHz | Egypt, Honduras, Indonesia, Malaysia |





CT40 XP FEATURE OVERVIEW

N6703 Standard Range

N6803 FlexRange™ Near/ Far Range



Warm Battery Swap



Display

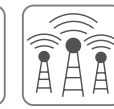

4G LTE / GPS



WiFi / BT



Scanner

Included in the box:

- CT40 Mobile Computer
- Battery (318-055-015)
- Hand strap

(Stylus is NOT included, but available to order separately as an accessory)

N6703 Standard Range



No Audio Jack / USB Type C
(WWAN Models CT40P-L1N-xxxxxBx)



N6803 FlexRange™



3.5mm Audio Jack / USB Type C
(WiFi Models Only CT40P-LON-xxxxxAx)

CT40 XP Android - 4G WWAN - N6703 Standard Range - 4GB RAM/ 32GB Flash

CT40P-L1N-27R11Bx

CT40 XP, WWAN, 4GB/32GB Memory, 5inch 1920x1080P full HD, N6703, 13MP Rear Camera/8MP Front Camera, 802.11 a/b/g/n/ac/r/k/mc, 2x2 MIMO, Bluetooth 5.0 & 2nd BLE, Android GMS, Warm Swap, IP67&65, Metal battery latch button, USB Type C OTG, PTT

CT40 XP Android - WiFi Only - N6803 FlexRange - 4GB RAM/ 32GB Flash

CT40P-LON-27R11Ax

CT40 XP, WLAN, 4GB/32GB Memory, 5inch 1920x1080P full HD, N6703, 13MP Rear Camera/8MP Front Camera, 802.11 a/b/g/n/ac/r/k/mc, 2x2 MIMO, Bluetooth 5.0 & 2nd BLE, Android GMS, Warm Swap, IP67&65, Metal battery latch button, 3.5mm Audio Jack, USB Type C OTG, PTT

CT40 XP Android - 4G WWAN - N6803 FlexRange - 4GB RAM/ 32GB Flash

CT40P-L1N-28R11Bx

CT40 XP, WWAN, 4GB/32GB Memory, 5inch 1920x1080P full HD, N6803 FlexRange, 13MP Rear Camera/8MP Front Camera, 802.11 a/b/g/n/ac/r/k/mc, 2x2 MIMO, Bluetooth 5.0 & 2nd BLE, Android GMS, Warm Swap, IP67&65, Metal battery latch button, USB Type C OTG, PTT

CT40 XP Android - WiFi Only - N6803 FlexRange - 4GB RAM/ 32GB Flash

CT40P-LON-28R11Ax

CT40 XP, WLAN, 4GB/32GB Memory, 5inch 1920x1080P full HD, N6803 FlexRange, 13MP Rear Camera/8MP Front Camera, 802.11 a/b/g/n/ac/r/k/mc, 2x2 MIMO, Bluetooth 5.0 & 2nd BLE, Android GMS, Warm Swap, IP67&65, Metal battery latch button, 3.5mm Audio Jack, USB Type C OTG, PTT

(Note: x = Domain, select appropriate Domain from Configuration Map on page 7)

Honeywell Repair Services

SVCCT40-SG3N

CT40 / CT40 XP, Edge Service, Gold Maintenance Contract, 3 Year, New Contract

ADD SVCREPLACE-MOB3

AddOn, Edge Service, Device Replacement, Mobility, 3 Year

CT40 XP FEATURE OVERVIEW

Disinfectant Ready Housing - N6703 Standard Range

Disinfectant Ready Housing - N6803 FlexRange™ Near/ Far Range



Warm Battery Swap



Display

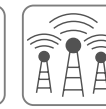

4G LTE / GPS



WiFi / BT



Scanner

Included in the box:

- CT40 Mobile Computer
- Battery (318-055-D67)
- Healthcare Hand strap

(Stylus is NOT included, but available to order separately as an accessory)

N6703 Standard Range

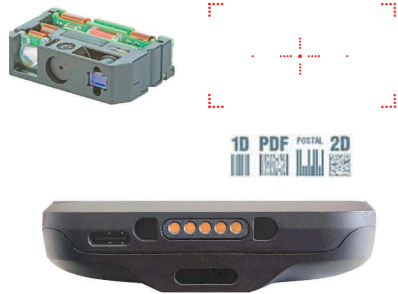

No Audio Jack / USB Type C
(WWAN Models CT40P-L1N-xxxxxBx)

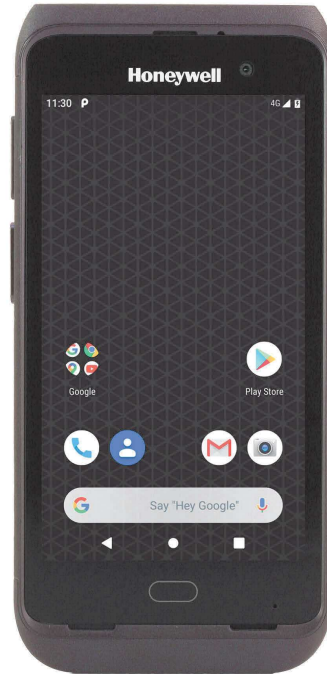

N6803 FlexRange™



3.5mm Audio Jack / USB Type C
(WiFi Models Only CT40P-LON-xxxxxAx)

CT40 XP Android - 4G WWAN - N6703 Standard Range - 4GB RAM/ 32GB Flash

CT40P-L1N-27R11Bx

CT40 XP, WWAN, 4GB/32GB Memory, 5inch 1920x1080P full HD, N6703, 13MP Rear Camera/8MP Front Camera, 802.11 a/b/g/n/ac/r/k/mc, 2x2 MIMO, Bluetooth 5.0 & 2nd BLE, Android GMS, Warm Swap, IP67&65, Metal battery latch button, USB Type C OTG, PTT

CT40 XP Android - WiFi Only - N6703 Standard Range - 4GB RAM/ 32GB Flash

CT40P-LON-27R11Ax

CT40 XP, WLAN, 4GB/32GB Memory, 5inch 1920x1080P full HD, N6703, 13MP Rear Camera/8MP Front Camera, 802.11 a/b/g/n/ac/r/k/mc, 2x2 MIMO, Bluetooth 5.0 & 2nd BLE, Android GMS, Warm Swap, IP67&65, Metal battery latch button, 3.5mm Audio Jack, USB Type C OTG, PTT

CT40 XP Android - 4G WWAN - N6803 FlexRange - 4GB RAM/ 32GB Flash

CT40P-L1N-28R11Bx

CT40 XP, WWAN, 4GB/32GB Memory, 5inch 1920x1080P full HD, N6803 FlexRange, 13MP Rear Camera/8MP Front Camera, 802.11 a/b/g/n/ac/r/k/mc, 2x2 MIMO, Bluetooth 5.0 & 2nd BLE, Android GMS, Warm Swap, IP67&65, Metal battery latch button, USB Type C OTG, PTT

CT40 XP Android - WiFi Only - N6803 FlexRange - 4GB RAM/ 32GB Flash

CT40P-LON-28R11Ax

CT40 XP, WLAN, 4GB/32GB Memory, 5inch 1920x1080P full HD, N6803 FlexRange, 13MP Rear Camera/8MP Front Camera, 802.11 a/b/g/n/ac/r/k/mc, 2x2 MIMO, Bluetooth 5.0 & 2nd BLE, Android GMS, Warm Swap, IP67&65, Metal battery latch button, 3.5mm Audio Jack, USB Type C OTG, PTT

(Note: x = Domain, select appropriate Domain from Configuration Map on page 7)

Honeywell Repair Services

SVCCT40-SG3N

CT40 / CT40 XP, Edge Service, Gold Maintenance Contract, 3 Year, New Contract

ADD SVCREPLACE-MOB3

AddOn, Edge Service, Device Replacement, Mobility, 3 Year

CT40 XP FEATURE OVERVIEW

Healthcare - N6700 Green Linear LED Aimer - Standard Range

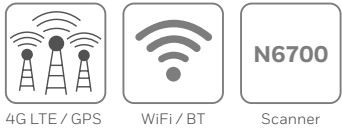

- Included in the box:
- CT40 Mobile Computer
 - Battery (318-055-017)
- (Stylus and Hand strap are NOT included, but available to order separately as an accessory)



CT40 Android - WWAN - N6700 - 4GB RAM/ 32GB Flash - Healthcare

CT40P-L1N-2LR11Hx

CT40 XP Healthcare, WWAN,4GB/32GB Memory, 5 inch 1920x1080P full HD, N6700 with linear LED aimer,13MP Rear Camera/8MP Front Camera,802.11 a/b/g/n/ac/r/k/mc,2x2 MIMO, BT5.0 & 2nd BLE, Android GMS, Smart Battery, Warm Swap,IP67&65,Metal battery latch button,PTT

CT40 Android - WiFi Only - N6700 - 4GB RAM/ 32GB Flash - Healthcare

CT40P-L0N-2LR11Hx

CT40 XP Healthcare, WLAN,4GB/32GB Memory, 5 inch 1920x1080P full HD, N6700 with linear LED aimer,13MP Rear Camera/8MP Front Camera,802.11 a/b/g/n/ac/r/k/mc,2x2 MIMO, BT5.0 & 2nd BLE, Android GMS, Smart Battery, Warm Swap,IP67&65,Metal battery latch button,PTT





(Note: x = Domain, select appropriate Domain from Configuration Map on page 6)

Honeywell Repair Services

| | |
|---------------------|---|
| SVCCT40-SG3N | CT40 / CT40 XP, Edge Service, Gold Maintenance Contract, 3 Year, New Contract |
| ADD SVCREPLACE-MOB3 | AddOn, Edge Service, Device Replacement, Mobility, 3 Year |

CT40 XP CONFIGURATION MAP

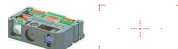
Android

| CT40P- | | | | | | | | | | | DESCRIPTION | NOTES | | | | |
|--|---|---|---|----|---|---|---|---|---|---|---|---|---|---|---|--|
|  | L | | | | | | | | | | 802.11 a/b/g/n/ac + Bluetooth 5.0 | 2x2 MIMO IEEE 802.11 a/b/g/n/ac/r/k/mc ; Wi-Fi certified V5.0 Bluetooth and BLE Supported Bluetooth Profiles: HFP,PBAP, A2DP, AVRCP, OPP, SPP, GATT | | | | |
| | | 0 | | | | | | | | | No WWAN | | | | | |
| | | 1 | | | | | | | | | LTE (4G) GPS, UMTS/HSPA+ (3G) GSM/GPRS/EDGE | WWAN RADIO (ATT/VZW/SPRINT/TMO/NA/EU) LTE (FDD) – BANDS 1,2,3,4,5,7,8,12,13,17,19,20,25,26,28,29 / LTE (TDD) – BANDS 38,39,40,41 UMTS/HSPA+ (3G) – BANDS 1, 2, 4, 5, 6, 8, 9, 19 / GSM/GPRS/EDGE QUAD-BAND (850/900/1800/1900 MHZ) | | | | |
| | | | N | | | | | | | | Near Field Communications (NFC) | | | | | |
| | | | | -- | | | | | | | | | | | | |
| | | | | | 2 | | | | | | 4GB RAM, 32GB Flash Memory | 2.2 GHz Qualcomm Snapdragon™ 660 octa-core | | | | |
| | | | | | | L | | | | | 1D/2D Imager (N6700) – Standard Range |  | | | | |
| | | | | | | | 7 | | | | 1D/2D Imager (N6703SR) – Standard Range |  | | | | |
| | | | | | | | | 8 | | | 1D/2D Imager (N6803FR) – FlexRange™ |  | | | | |
| | | | | | | | | | R | | 13MP Rear Camera / 8MP Front Facing Camera | | | | | |
| | | | | | | | | | | 1 | | Android (GMS) | Google Mobile Services (GMS) certified – Play Store | | | |
| | | | | | | | | | | | 2 | | Android (Non-GMS) | | | |
| | | | | | | | | | | | | 1 | | Standard Software Build | | |
| | | | | | | | | | | | | | D | | WWAN Data Only | |
| | | | | | | | | | | | | A | | Audio Jack – New Battery Latch – USB Type C OTG (On The Go) | 3.5mm Audio Jack - supports PTT, VOIP – Only available on WiFi Only models (CT40P-LO-xxxxxx) | |
| | | | | | | | | | | | | B | | No Audio Jack – New Battery Latch – USB Type C OTG (On The Go) | | |
| | | | | | | | | | | | | D | | Disinfectant Ready Housing - Honeywell Grey Colour | Disinfectant Ready Housings (DRHs). DRHs utilize plastics designed to withstand the harshness of frequent cleaning with disinfectants without compromising the lifespan of the equipment. | |
| | | | | | | | | | | | | H | | Healthcare - White | CT40 Healthcare is made from disinfectant-ready materials that are designed to withstand frequent cleaning using approved disinfecting and sanitizing agents. | |
| | | | | | | | | | | | E | | WorldWide | Argentina, Australia, Austria, Belgium, Brazil, Bulgaria, Columbia, Croatia, Cyprus, Czech Republic, Denmark, Dominican Republic, Egypt, Estonia, Finland, France, Germany, Greece, Honduras, Hong Kong, Iceland, India, Indonesia, Ireland, Italy, Japan, Jordan, Kuwait, Latvia, Liechtenstein, Lithuania, Luxembourg, Malaysia, Malta, Morocco, Netherlands, New Zealand, Norway, Oman, Poland, Portugal, Qatar, Romania, Russia, Saudi Arabia, Singapore, Slovakia, Slovenia, South Africa, South Korea, Spain, Sri Lanka, Sweden, Switzerland, Thailand, UAE, Ukraine, United Kingdom, Vietnam | | |
| | | | | | | | | | | | F | | FCC | USA, Canada, Guatemala, Mexico, Panama, Paraguay, Puerto Rico, Taiwan, Venezuela | | |
| | | | | | | | | | | | T | | Turkey | WWAN Data Only | | |
| | | | | | | | | | | | I | | Indonesia | WWAN 3G Radio | | |



HONEYWELL EDGE SERVICES

CT40 / CT40 XP – Repair Services

Honeywell Edge Services give you the confidence of having leading-class technologies combined with service and support plans that are designed to keep you operational for longer.

Gold Repair Services – 3 Year

The most flexible contract in the industry. The Edge Services Gold Support contract allows you to select the right coverage for your organization, and includes 5-Day Depot Repairs and:

Service Overview

- Repair or replacement of damaged components, wear and tear, and accidental damage.
- Flexibility to add any Add-On Service

| PART NUMBER | DESCRIPTION |
|--------------|---|
| SVCCT40-SG3N | CT40 / CT40 XP, Edge Service, GOLD Maintenance Contract, 5 Day Turnaround, 3 Year , New Contract |

Add-On Accessory Replacement Service

Provides replacement chargers, docks, charging cables, or scan handles should they be damaged or stop working.

| | | |
|------------|-------------|---|
| ADD | SVCACC-MOB3 | AddOn, Edge Service, Accessory Service, Mobility, 3 Year . Service covers docks, charger cradles, scan handles |
|------------|-------------|---|

Add-On Battery Replacement Service

Provides replacement batteries every 18 months after purchase.

| | | |
|------------|-----------------|---|
| ADD | SVCBATTERY-MOB3 | AddOn, Edge Service, Battery Service, Mobility, 3 Year , 1 Replacement Battery over life of contract |
|------------|-----------------|---|

Add-On Device Replacement Service

Replacement devices should a device be damaged beyond repair.

| | | |
|------------|-----------------|--|
| ADD | SVCREPLACE-MOB3 | AddOn, Edge Service, Device Replacement, Mobility, 3 Year |
|------------|-----------------|--|

Add-On Image Management Service

Ensures that when a device returns from being repaired, it has all the proper applications loaded back on the device.

| | | |
|------------|-------------------|---|
| ADD | SVCIMAGEMGMT-MOB3 | AddOn, Edge Service, Image Service, Mobility, 3 Year |
|------------|-------------------|---|

Add-On Spare Management Service

Manages every aspect of your spare pool.

| | | |
|------------|-------------------|---|
| ADD | SVCSPAREMGMT-MOB3 | AddOn, Edge Service, Advanced Exchange, Mobility, 3 Year . Customer owned spare pool. Minimum Purchase required, contact your local Honeywell Service Representative for more information. |
|------------|-------------------|---|

Add-On Sentinel Extended Service

Security patches and minor enhancements to legacy Android operating systems, typically added after year 3.

| | | |
|------------|-----------------|--|
| ADD | SVSENTINEL-MOB1 | Sentinel Service, 1 Year Android Support Contract |
|------------|-----------------|--|

| | | |
|------------|-----------------|--|
| ADD | SVSENTINEL-MOB2 | Sentinel Service, 2 Year Android Support Contract |
|------------|-----------------|--|

Platinum Repair Services – 3 Year

The Edge Services Platinum Support contract is the only total support contract in the industry today offering 2-Day Depot Repairs or Spare Pool Management with 3-year contract, that includes:

Service Overview

- Repair or replacement of damaged components
- SVCREPLACE-MOB3 – Replacement devices should a device be damaged beyond repair
- SVCACC-MOB3 – Accessory replacement service
- SVCBATTERY-MOB3 – Battery replacement service
- PPSW-OPINTEL-PMP36 – Operational Intelligence Performance Professional licenses
- SVCSPAREMGMT-MOB3 – Spare pool management (optional, minimum quantity required)
- Telephone-based technical support
- Sentinel Extended Service that protects customers for future security updates on Android.

| PART NUMBER | DESCRIPTION |
|--------------|--|
| SVCCT40-SP3N | CT40 / CT40 XP, Edge Service, PLATINUM, 2 Day Turnaround, 3 Year, New Contract |

OPERATIONAL INTELLIGENCE SETUP MUST BE ORDERED WITH PLATINUM EDGE SERVICE CONTRACT

| | |
|------------------|---|
| PPPS-OIPLI-SETUP | OpIntel Free Platinum Installation Basic & Professional |
|------------------|---|



HONEYWELL EDGE SERVICES

CT40 / CT40 XP – Repair Services

Honeywell Edge Services give you the confidence of having leading-class technologies combined with service and support plans that are designed to keep you operational for longer.

Gold Repair Services – 5 Year

The most flexible contract in the industry. The Edge Services Gold Support contract allows you to select the right coverage for your organization, and includes 5-Day Depot Repairs and:

Service Overview

- Repair or replacement of damaged components, wear and tear, and accidental damage.
- Flexibility to add any Add-On Service

| PART NUMBER | DESCRIPTION |
|--------------|---|
| SVCCT40-SG5N | CT40 / CT40 XP, Edge Service, GOLD Maintenance Contract, 5 Day Turnaround, 5 Year , New Contract |

Add-On Accessory Replacement Service

Provides replacement chargers, docks, charging cables, or scan handles should they be damaged or stop working.

| | | |
|-----|-------------|--|
| ADD | SVCACC-MOB5 | AddOn, Edge Service, Accessory Service , Mobility, 5 Year . Service covers docks, charger cradles, scan handles |
|-----|-------------|--|

Add-On Battery Replacement Service

Provides replacement batteries every 18 months after purchase.

| | | |
|-----|-----------------|---|
| ADD | SVCBATTERY-MOB5 | AddOn, Edge Service, Battery Service, Mobility, 5 Year , 2 Replacement Battery over life of contract |
|-----|-----------------|---|

Add-On Device Replacement Service

Replacement devices should a device be damaged beyond repair.

| | | |
|-----|-----------------|--|
| ADD | SVCREPLACE-MOB5 | AddOn, Edge Service, Device Replacement, Mobility, 5 Year |
|-----|-----------------|--|

Add-On Image Management Service

Ensures that when a device returns from being repaired, it has all the proper applications loaded back on the device.

| | | |
|-----|-------------------|---|
| ADD | SVCIMAGEMGMT-MOB5 | AddOn, Edge Service, Image Service, Mobility, 5 Year |
|-----|-------------------|---|

Add-On Spare Management Service

Manages every aspect of your spare pool.

| | | |
|-----|-------------------|---|
| ADD | SVCSPAREMGMT-MOB5 | AddOn, Edge Service, Advanced Exchange, Mobility, 5 Year . Customer owned spare pool, Minimum Purchase required, contact your local Honeywell Service Representative for more information. |
|-----|-------------------|---|

Add-On Sentinel Extended Service

Security patches and minor enhancements to legacy Android operating systems, typically added after year 3.

| | | |
|-----|------------------|--|
| ADD | SVCSENTINEL-MOB1 | Sentinel Service, 1 Year Android Support Contract |
|-----|------------------|--|

| | | |
|-----|------------------|--|
| ADD | SVCSENTINEL-MOB2 | Sentinel Service, 2 Year Android Support Contract |
|-----|------------------|--|

Platinum Repair Services – 5 Year

The Edge Services Platinum Support contract is the only total support contract in the industry today offering 2-Day Depot Repairs or Spare Pool Management with 5-year contract, that includes:

Service Overview

- Repair or replacement of damaged components
- SVCREPLACE-MOB5 - Replacement devices should a device be damaged beyond repair
- SVCACC-MOB5 - Accessory replacement service
- SVCBATTERY-MOB5 - Battery replacement service
- PPSW-OPINTEL-PMP60 - Operational Intelligence Performance Professional licenses
- SVCSPAREMGMT-MOB5 - Spare pool management (optional, minimum quantity required)
- Telephone-based technical support
- Sentinel Extended Service that protects customers for future security updates on Android. The 5 year Sentinel coverage provides extended Android updates in years 4 and 5.

| PART NUMBER | DESCRIPTION |
|--------------|--|
| SVCCT40-SP5N | CT40 / CT40 XP, Edge Service, PLATINUM, 2 Day Turnaround, 5 Year, New Contract |

| OPERATIONAL INTELLIGENCE SETUP MUST BE ORDERED WITH PLATINUM EDGE SERVICE CONTRACT | |
|--|---|
| PPPS-OIPLI-SETUP | OpIntel Free Platinum Installation Basic & Professional |



HONEYWELL REPAIR SERVICES

CT40 / CT40 XP - Repair Services Coverage

For Best-In-Class Service

CT40 / CT40 XP



Warranty Cover Against Product Defect

BASIC Service

Gold Coverage:

- Accidental Damage
- Wear & Tear

Includes Replacement of:

- Handstrap
- Screen Protector



Flexible GOLD Add-Ons ordered separately

- SVCACC-MOB3 Accessories
- SVCBATTERY-MOB3 Batteries
- SVCREPLACE-MOB3 Device Replacement
- SVCIMAGEMGMT-MOB3 Image Service
- SVCSPAREMGMT-MOB3 Advanced Exchange

GOLD Service

Platinum Coverage

- Battery Replacement
- Coverage for Docks/ Chargers
- Sentinel Extended Service for Android Security Updates
- Accidental Damage
- Device Replacement
- Wear & Tear



Pistol Grip



Battery
(3 Year – 1 replacement battery per CT40)
(5 Year – 2 replacement batteries per CT40)



Vehicle Dock



Docks



Car Chargers



Dock Power Supplies

PLATINUM Service

| PART NUMBER | DESCRIPTION |
|-----------------------|--|
| SVCCT40-EXW2 | CT40 / CT40 XP, BASIC, 10-15 Day Turnaround, 2 Years (1 Year Factory Warranty + 1 Year Extended) |
| SVCCT40-SG3N | CT40 / CT40 XP, Edge Service, GOLD Maintenance Contract, 5 Day Turnaround, 3 Year, New Contract |
| ADD SVCACC-MOB3 | AddOn, Edge Service, Accessory Service , Mobility, 3 Year. Service covers docks, charger cradles, scan handles and car adapter |
| ADD SVCBATTERY-MOB3 | AddOn, Edge Service, Battery Service, Mobility, 3 Year, 1 Replacement Battery over life of contract |
| ADD SVCREPLACE-MOB3 | AddOn, Edge Service, Device Replacement, Mobility, 3 Year |
| ADD SVCIMAGEMGMT-MOB3 | AddOn, Edge Service, Image Service, Mobility, 3 Year |
| ADD SVCSPAREMGMT-MOB3 | AddOn, Edge Service, Advanced Exchange, Mobility, 3 Year. Customer owned spare pool, Minimum Purchase required. |
| SVCCT40-SP3N | CT40 / CT40 XP, Edge Service, PLATINUM, 2 Day Turnaround, 3 Year, New Contract |

CT40 / CT40 XP SOFTWARE

Device Client Pack

Device Client Pack (DCP) includes first year maintenance. Add additional years of software maintenance for the applications below.

Device Client Pack



Launcher - gives the customer total control over which apps can be run on the device.

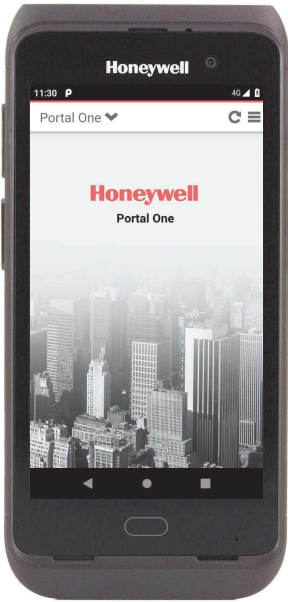

Enterprise Browser provides corporations the ability to run standard web applications from a controlled environment.

| PART NUMBER | DESCRIPTION |
|-------------|--|
| DCP-001 | Device Client Pack License (Launcher & Enterprise Browser) |
| DCP-SFT1 | Device Client Pack - 1 Year Maintenance (Launcher, Enterprise Browser) |
| DCP-SFT3 | Device Client Pack - 3 Year Maintenance (Launcher, Enterprise Browser) |

Order Separately



Terminal Emulator – Full featured SmartTE allows legacy green screen apps to be transformed to the look and feel of native apps. These clients are single session Honeywell TE Licensing. They can also utilize traditional single or multi-session StayLinked Licenses.

| PART NUMBER | DESCRIPTION |
|--------------|--|
| SMARTTE-001 | SMARTTE - SINGLE PATH W-1 Year Maintenance |
| SMARTTE-SFT3 | SMARTTE – 3 Year Software Maintenance |
| SMARTTE-SFT5 | SMARTTE – 5 Year Software Maintenance |

CT40 / CT40 XP SCANNING

Scan Handle Side by Side Comparison

Use for Scan intensive applications.



| | PART NUMBER | DESCRIPTION |
|---|-------------|--|
| 1 | CT40-SH-DC | CT40 Scan Handle |
| 2 | CT40-SH-PB | Kit, CT40 scan handle includes TPU boot (CT40-PB-XP), compatible with CT40 and CT40 XP |
| 3 | CT40-SH-CC | CT40 Scan Handle Uncover Camera |

CT40 / CT40 XP SCANNING

Option 1 - Scan Handle

Use for Scan intensive applications.



CT40 with Scan Handle Installed on Home Base

| PART NUMBER | | DESCRIPTION | | | |
|-------------|------------|--|------------------------------------|-------------------------------|----------------------------------|
| 1 | CT40-SH-DC | CT40 Scan Handle Compatible for use with Home Base and Charge Base without removal. | | | |
| | | CT40-HB-0 / CT40-HB-UVN-0 | Home Base | CT40-CB-CNV-0 / CT40-CB-UVN-0 | Quad Charge Base |
| | | CT40-EB-0 / CT40-EB-UVN-0 | Ethernet Home Base | CT40-NB-CNV-0 / CT40-NB-UVN-0 | Quad Net Base |
| | | CT40-DB-0 / CT40-DB-UVN-0 | Display Base | | |
| | | Not Compatible with the Protective Boot Bases | | | |
| | | CT40-HB-UVB-0 | Protective Boot Home Base | | |
| | | CT40-EB-UVB-0 | Protective Boot Ethernet Home Base | | |
| | | CT40-DB-UVB-0 | Protective Boot Display Base | | |
| | | CT40-CB-PB-0 | Protective Boot Quad Charge Base | CT40-CB-UVB-0 | Protective Boot Quad Charge Base |
| | | CT40-NB-PB-0 | Protective Boot Quad Net Base | CT40-NB-UVB-0 | Protective Boot Quad Net Base |

CT40 / CT40 XP SCANNING

Option 2 - Scan Handle with Protective Boot

Use for Scan intensive applications with additional protection of the protective boot.
This scan handle is ONLY compatible with protective boot charging docks.



| PART NUMBER | | DESCRIPTION | | | | | |
|-------------|---------------------------|---|--------------------|------------------------------------|-------------------------------|------------------|----------------------------------|
| 1 | CT40-SH-PB | Kit, CT40 scan handle and includes TPU boot (CT40-PB-XP) compatible with CT40 and CT40 XP Compatible for use with Protective Boot Home Base and Charge Base without removal. | | | | | |
| | | CT40-HB-UVB-0 | | Protective Boot Home Base | | | |
| | | CT40-EB-UVB-0 | | Protective Boot Ethernet Home Base | | | |
| | | CT40-DB-UVB-0 | | Protective Boot Display Base | | | |
| | | CT40-CB-PB-0 | | Protective Boot Quad Charge Base | | CT40-CB-UVB-0 | Protective Boot Quad Charge Base |
| | | CT40-NB-PB-0 | | Protective Boot Quad Net Base | | CT40-NB-UVB-0 | Protective Boot Quad Net Base |
| | | Not Compatible with the Non-Protective Boot Bases | | | | | |
| | CT40-HB-0 / CT40-HB-UVN-0 | | Home Base | | CT40-CB-CNV-0 / CT40-CB-UVN-0 | Quad Charge Base | |
| | CT40-EB-0 / CT40-EB-UVN-0 | | Ethernet Home Base | | CT40-NB-CNV-0 / CT40-NB-UVN-0 | Quad Net Base | |
| | CT40-DB-0 / CT40-DB-UVN-0 | | Display Base | | | | |

CT40 / CT40 XP SCANNING

Option 3 - Scan Handle for use with Camera

Use for Scan intensive applications as well as unimpeded access to the Camera.



CT40 with Scan Handle Installed on Home Base

| PART NUMBER | | DESCRIPTION | | | |
|-------------|------------|---|------------------------------------|-------------------------------|----------------------------------|
| 1 | CT40-SH-CC | CT40 Scan Handle Uncover Camera Compatible for use with Home Base and Charge Base without removal. | | | |
| | | CT40-HB-0 / CT40-HB-UVN-0 | Home Base | CT40-CB-CNV-0 / CT40-CB-UVN-0 | Quad Charge Base |
| | | CT40-EB-0 / CT40-EB-UVN-0 | Ethernet Home Base | CT40-NB-CNV-0 / CT40-NB-UVN-0 | Quad Net Base |
| | | CT40-DB-0 / CT40-DB-UVN-0 | Display Base | | |
| | | Not Compatible with the Protective Boot Bases | | | |
| | | CT40-HB-UVB-0 | Protective Boot Home Base | | |
| | | CT40-EB-UVB-0 | Protective Boot Ethernet Home Base | | |
| | | CT40-DB-UVB-0 | Protective Boot Display Base | | |
| | | CT40-CB-PB-0 | Protective Boot Quad Charge Base | CT40-CB-UVB-0 | Protective Boot Quad Charge Base |
| | | CT40-NB-PB-0 | Protective Boot Quad Net Base | CT40-NB-UVB-0 | Protective Boot Quad Net Base |

CT40 / CT40 XP DESKTOP COMMUNICATIONS

Option 1 – Portable – Non-Booted

USB Communication to PC/ Mac OR Snap-On Charging.



| | PART NUMBER | DESCRIPTION |
|---|---------------|---|
| 1 | CT40-SN-USB-0 | Snap-on cup with Standard Type A connector. |
| 2 | 50136024-001 | KIT,5V/2A PS,5 PLUGS PACKED, ROW Includes US,UK,AU,EU,IN adapters |

Option 2 – Portable – Non-Booted or Booted

USB Communication to PC/ Mac OR Snap-On Charging.



| | PART NUMBER | DESCRIPTION |
|---|-------------|--|
| 1 | CT40-SN-CNV | Snap on adaptor for charging CT40 with or without boot with a convertible adaptor. Provides tethered USB client connectivity. Compatible with hand strap, battery pack, and scan handle. Charges mobile computer battery in four hours or less. Kit includes snap-on adaptor with convertible adaptor. Optional 50136024-001 (5 V/2 A) USB power wall adapter sold separately. |

CT40 XP COMMUNICATIONS

Option 3 – CT40 XP USB Type C On-The-Go (OTG) Desktop

USB C Communication to PC/ Mac OR Charging.
Only Compatible with CT40 XP.

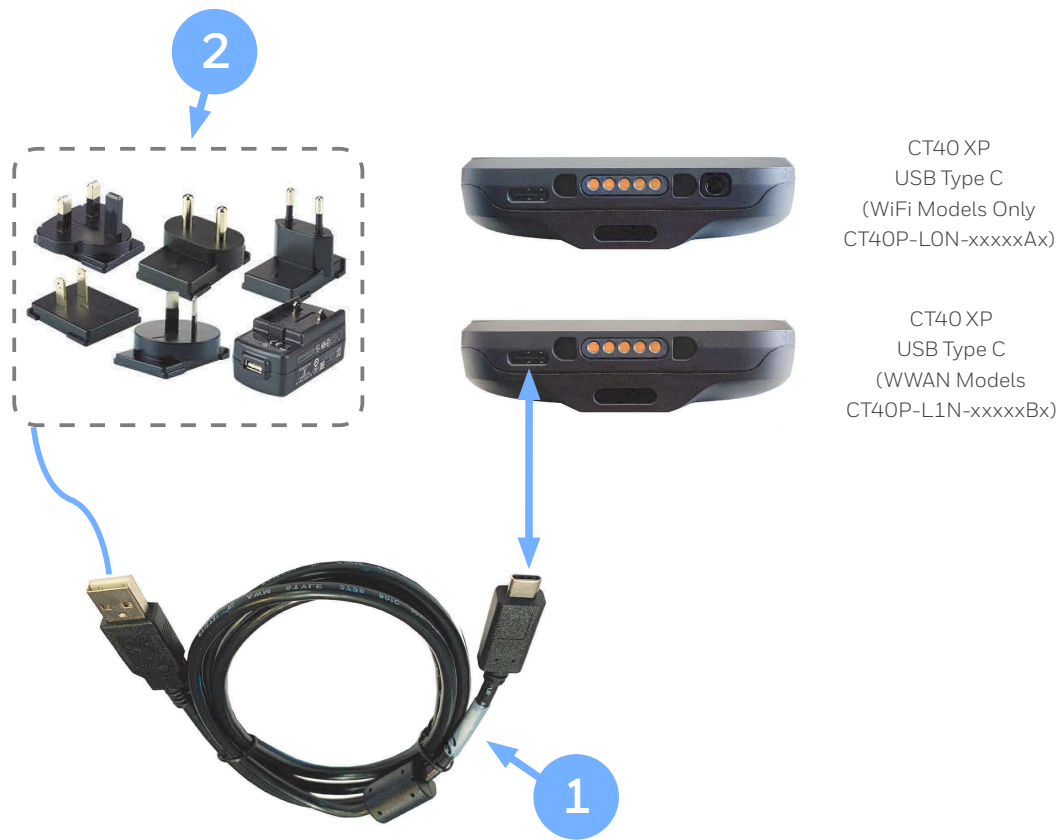

| PART NUMBER | DESCRIPTION |
|-------------|--|
| 1 | CBL-500-120-S00-05 USB type A to type C, 1,2 m (3.9 ft) |
| 2 | 50136024-001 KIT,5V/2A PS,5 PLUGS PACKED, ROW Includes US,UK,AU,EU,IN adapters |

Option 4 – CT40 XP USB Type C On-The-Go (OTG) Vehicle

USB C Communication to Vehicle OR Charging.
Only Compatible with CT40 XP.



| PART NUMBER | DESCRIPTION |
|-------------|--|
| 1 | CBL-500-120-S00-05 USB type A to type C, 1,2 m (3.9 ft) |
| 2 | CT40-CIGR-0 Accessory Cigarette Lighter Power Adapter with USB Socket (Provides 12 V/24 V cigarette lighter port to USB type-A power adapter for snap-on use in a vehicle) |

CT40 / CT40 XP DESKTOP COMMUNICATIONS

Option 5 – Fixed

USB and optional Ethernet Communication & Single Battery Charger.
Not Compatible with CT40-RB-00 Rubber Boot or CT40-PB-00 / CT40-PB-XP Protective Boot



| | PART NUMBER | DESCRIPTION |
|----|-------------|---|
| 1 | CT40-HB-0 | HomeBase - Kit includes Dock & Power Supply, must order Power Cord separately |
| OR | CT40-EB-0 | eHomeBase - Ethernet Kit includes Dock & Power Supply, must order Power Cord separately |
| 2 | 321-576-004 | Cable Assembly - USB Type A to Type B |
| 3 | ** | AC Power Cord - See Page 38 for Country Specific Power Cords |

Option 6 – Fixed with Universal Cup

USB and optional Ethernet Communication & Single Battery Charger.
Not Compatible with CT40-RB-00 Rubber Boot



| | PART NUMBER | DESCRIPTION |
|----|---------------|---|
| 1A | CT40-HB-UVN-0 | Non-Booted HomeBase - Kit includes (CT40-UCP-N), Dock & Power Supply, No Power Cord |
| OR | CT40-EB-UVN-0 | Non-Booted eHomeBase - Ethernet Kit includes (CT40-UCP-N), Dock & Power Supply, No Power Cord |
| 1B | CT40-HB-UVB-0 | Booted HomeBase - Kit includes (CT40-UCP-B), Dock & Power Supply, No Power Cord |
| OR | CT40-EB-UVB-0 | Booted eHomeBase - Ethernet Kit includes (CT40-UCP-B), Dock & Power Supply, No Power Cord |
| 2 | 321-576-004 | Cable Assembly - USB Type A to Type B |
| 3 | ** | AC Power Cord - See Page 38 for Country Specific Power Cords |

CT40 / CT40 XP DESKTOP COMMUNICATIONS

Option 7 – Display Base

Connect USB peripherals (keyboard, mouse) and External Monitor via HDMI.



| PART NUMBER | DESCRIPTION |
|-------------|---|
| 1 CT40-DB-0 | Display Dock - Kit includes Dock & Power Supply, must order Power Cord separately |
| 2 ** | AC Power Cord – See Page 38 for Country Specific Power Cords |

Option 8 – Display Base with Universal Cup

Connect USB peripherals (keyboard, mouse) and External Monitor via HDMI.



| PART NUMBER | DESCRIPTION |
|------------------|--|
| 1A CT40-DB-UVN-0 | Non-Booted Display Dock - Kit includes (CT40-UCP-N), Display Base & Power Supply, No Power Cord |
| 1B CT40-DB-UVB-0 | Booted Display Dock - Kit includes (CT40-UCP-B), Display Base & Power Supply, No Power Cord |
| 2 ** | AC Power Cord – See Page 38 for Country Specific Power Cords |

CT40 / CT40 XP VEHICLE INSTALL

Option 1 – Portable/ Sub Contractor Install

Simple Vehicle Charging, portable between vehicles.
Compatible with CT40 and CT40 XP with or without CT40-PB-XP Protective Boot installed.



| PART NUMBER | DESCRIPTION |
|---------------|--|
| 1 CT40-SN-CNV | Snap on adaptor for charging CT40 with or without boot with a convertible adaptor. Provides tethered USB client connectivity. Compatible with hand strap, battery pack, and scan handle. Charges mobile computer battery in four hours or less. Kit includes snap-on adaptor with convertible adaptor. |
| 2 CT40-CIGR-0 | Accessory Cigarette Lighter Power Adapter with USB Socket (Provides 12 V/24 V cigarette lighter port to USB type-A power adapter for snap-on use in a vehicle) |

Option 2 – Portable/ Sub Contractor Install

Windscreen Suction Cup Mount, portable between vehicles.
Compatible with CT40 and CT40 XP with or without CT40-PB-XP Protective Boot installed.



| PART NUMBER | DESCRIPTION |
|------------------|--|
| 1 CT40-VD-CNV | CT40 Booted or Non-Booted Vehicle Dock w/ hard wired 3-pin power cable |
| 2 RAM-B-166-202U | Suction Cup Mount Kit |
| 3 50138169-001 | Cigarette Lighter Power Adapter Cable |

CT40 / CT40 XP VEHICLE INSTALL

Option 3 - Fixed Vehicle Install with Direct Connection to Vehicle Battery

Best used when the vehicle input voltage varies, 10- 30V.
Compatible with CT40 and CT40 XP with or without CT40-PB-XP Protective Boot installed.



| PART NUMBER | DESCRIPTION | |
|-------------|-------------|---|
| 1 | CT40-VD-CNV | CT40 Booted or Non-Booted Vehicle Dock w/ hard wired 3-pin power cable |
| 2 | 203-802-001 | Vehicle Dock Installation Kit (Power Option: For connection of Vehicle Dock directly to vehicle battery. Includes power cables and cable mounting hardware) |
| 3 | 805-611-001 | Mounting Kit, V-Dock RoHS |

CT40 / CT40 XP VEHICLE INSTALL

Option 4 - Fixed Vehicle Install with Direct Connection to Vehicle Battery/ Fuse Block

Best used when the vehicle input voltage varies, 10- 30V.
Compatible with CT40 and CT40 XP with or without CT40-PB-XP Protective Boot installed.



| PART NUMBER | DESCRIPTION | |
|-------------|-------------|--|
| 1 | CT40-VD-CNV | CT40 Booted or Non-Booted Vehicle Dock w/ hard wired 3-pin power cable |
| 2 | 226-109-003 | 72" (182.88 cm) Fuse block Power Cable with spade lugs and 3-pin connector |
| OR | 226-109-004 | 22" (55.8 cm) Fuse block Power Cable with spade lugs and 3-pin connector |
| 3 | 805-611-001 | Mounting Kit, V-Dock RoHS |
| OPTIONAL | 203-803-001 | Vehicle Dock Fuse Block Power Kit RoHS (Provides connection to vehicle fuse block). Requires Power Cable (226-109-003 or 226-109-004). |

CT40 / CT40 XP VEHICLE INSTALL

Option 5 - Fixed Vehicle Install with Thor DC/DC Converter

Best used when the vehicle input voltage varies, 9-60V or 50-150V.
Compatible with CT40 and CT40 XP with or without CT40-PB-XP Protective Boot installed.



| PART NUMBER | DESCRIPTION |
|-------------|---|
| 1 | CT40-VD-CNV CT40 Booted or Non-Booted Vehicle Dock w/ hard wired 3-pin power cable |
| 2 | 9000311PWRSPLY DC/DC Converter Kit, 9-60V DC, RoHS (Requires 226-109-003 Wiring Harness) |
| OR | 9000313PWRSPLY DC/DC Converter Kit, 50-150V DC RoHS (Requires 226-109-003 Wiring Harness) |
| | 226-109-003 72" (182.88 cm) Fuse block Power Cable with spade lugs and 3-pin connector |
| 3 | 805-611-001 Mounting Kit, V-Dock RoHS |

CT40 / CT40 XP VEHICLE INSTALL

CT40 Vehicle Dock 360 degree view



Front View



Front View
CT40 Non-Booted



Front View
CT40 Booted

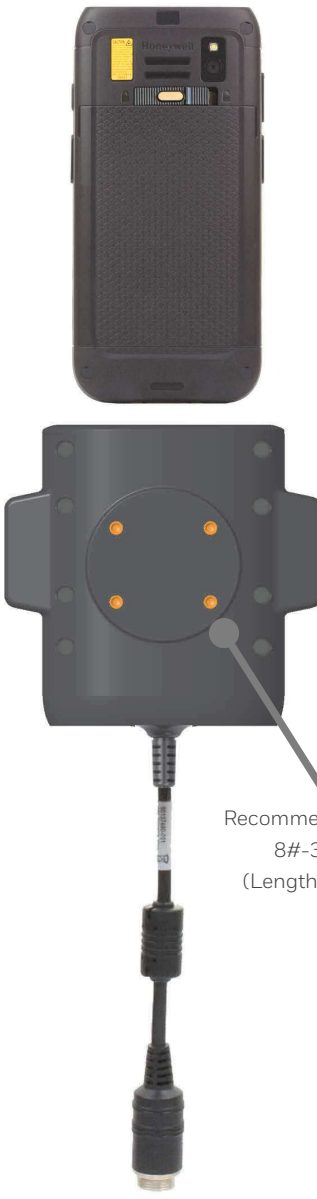

Recommended Screws
8#-32-UNC
(Length = 0.5 inch)

Rear View



Side View

CT40 / CT40 XP CHARGING AND COMMUNICATION

Option 1 - Non-Booted Quad Charger

Chargebase – Quad Dock Charge Only
Netbase – Quad Dock with Ethernet
Not Compatible with CT40-RB-00 Rubber Boot or CT40-PB-00 / CT40-PB-XP Protective Boot

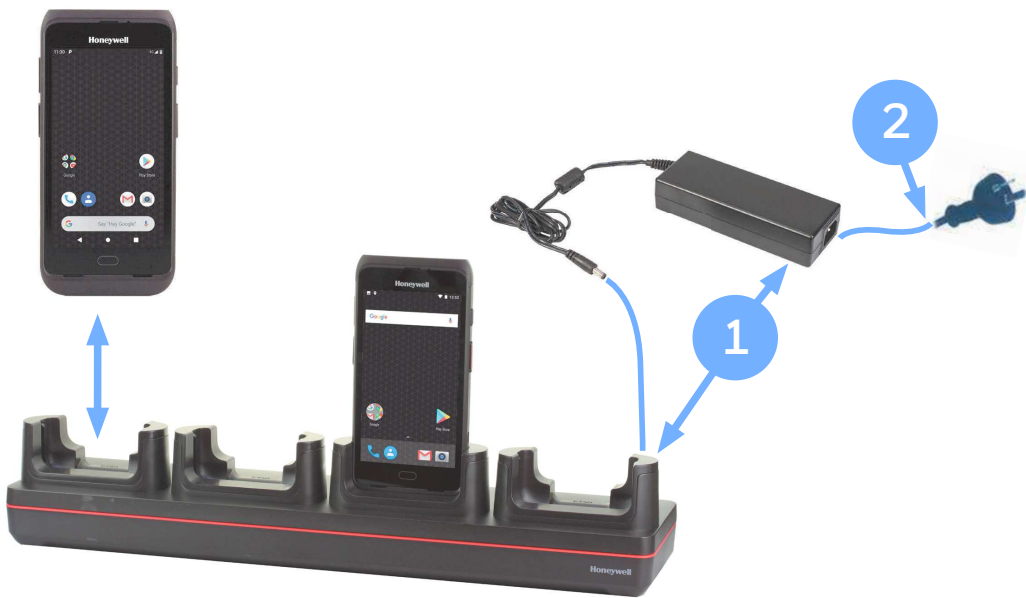

| | PART NUMBER | DESCRIPTION |
|----|---------------|--|
| 1 | CT40-CB-CNV-0 | Chargebase - Kit includes Dock and Power Supply |
| OR | CT40-NB-CNV-0 | Netbase - For Ethernet comms, Kit includes Dock and Power Supply |
| 2 | ** | AC Power Cord – See Page 38 for Country Specific Power Cords |

Option 2 - Non-Booted Quad Charger with Universal Cup

Chargebase – Quad Dock Charge Only
Netbase – Quad Dock with Ethernet
Not Compatible with CT40-RB-00 Rubber Boot or CT40-PB-00 / CT40-PB-XP Protective Boot



Kit Includes:
4 x CT40-UCP-N
CT40 Cup for Non-Booted

| | PART NUMBER | DESCRIPTION |
|----|---------------|--|
| 1 | CT40-CB-UVN-0 | Non-Booted Chargebase - Kit includes Dock and Power Supply |
| OR | CT40-NB-UVN-0 | Non-Booted Netbase - For Ethernet comms, Kit includes Dock and Power Supply |
| 2 | ** | AC Power Cord – See Page 38 for Country Specific Power Cords |

CT40 / CT40 XP CHARGING AND COMMUNICATION

Option 3 - Booted Quad Charger

Chargebase – Quad Dock Charge Only
Netbase – Quad Dock with Ethernet
Compatible with CT40-PB-00 / CT40-PB-XP Protective Boot

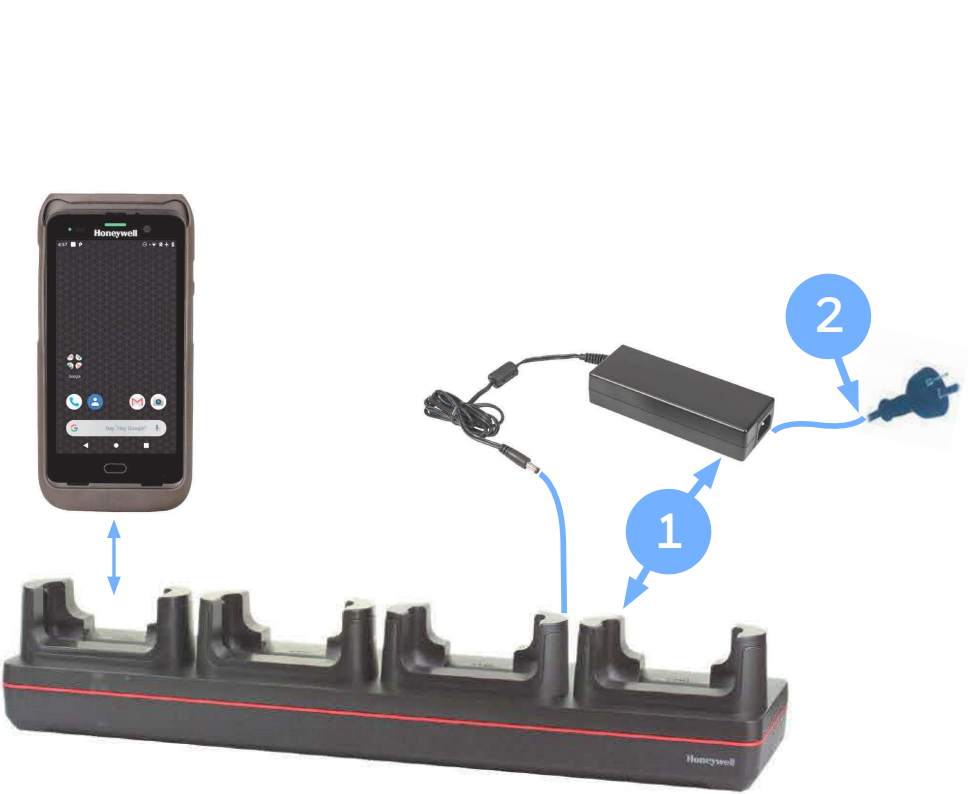

| | PART NUMBER | DESCRIPTION |
|----|--------------|---|
| 1 | CT40-CB-PB-0 | Booted Chargebase - Kit includes Dock and Power Supply |
| OR | CT40-NB-PB-0 | Booted Netbase - For Ethernet comms, Kit includes Dock and Power Supply |
| 2 | ** | AC Power Cord – See Page 38 for Country Specific Power Cords |

Option 4 - Booted Quad Charger with Universal Cup

Chargebase – Quad Dock Charge Only
Netbase – Quad Dock with Ethernet
Compatible with CT40-PB-00 / CT40-PB-XP Protective Boot



Kit Includes:
4 x CT40-UCP-B
CT40 Cup for Booted

| | PART NUMBER | DESCRIPTION |
|----|---------------|---|
| 1 | CT40-CB-UVB-0 | Booted Chargebase - Kit includes Dock and Power Supply |
| OR | CT40-NB-UVB-0 | Booted Netbase - For Ethernet comms, Kit includes Dock and Power Supply |
| 2 | ** | AC Power Cord – See Page 38 for Country Specific Power Cords |

CT40 / CT40 XP CHARGING AND COMMUNICATION

Option 5 - Quad Battery Charger

Charge up to 4 batteries simultaneously

- Supports Batteries:
- 318-055-010 - Battery, Standard, CT40 (4090mAh)
 - 318-055-014 - Battery, Standard, CT40 (4090mAh)
 - 318-055-015 - Battery, Standard, CT40 (4040mAh)
 - 318-055-017 - Battery, Standard, CT40 Healthcare (4020mAh)
 - 318-055-D67 - Battery, Standard, CT40 DRH (4020mAh)

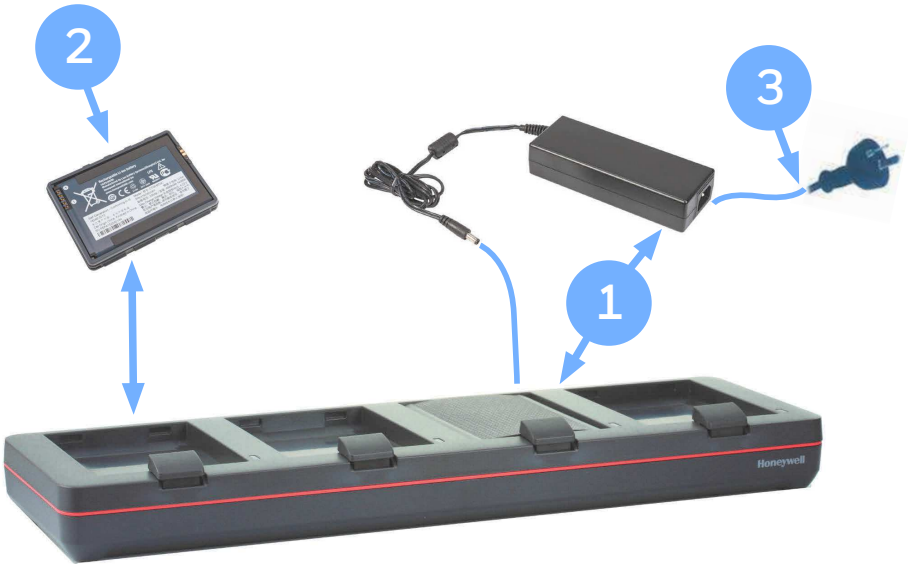

| | PART NUMBER | DESCRIPTION |
|----|-------------|---|
| 1 | CT40-QBC-0 | Quad Battery Charger - Kit includes Dock and Power Supply |
| 2 | 318-055-015 | CT40 Gen 2 Battery Pack, 4040mAh |
| OR | 318-055-017 | CT40 HC battery Pack, 3.85V, 4020mAh, White cover, Healthcare |
| 3 | ** | AC Power Cord – See Page 38 for Country Specific Power Cords |

CT40 / CT40 XP RFID

IH21 RFID Reader for CT40 / CT40 XP

Connect the IH21 to the CT40 via Bluetooth.



IH21 Charging Cradle

| | PART NUMBER | REGION | DESCRIPTION |
|----------|---------------|--------|---|
| 1 | IH21A0020 | AUS | IH21 Bluetooth RFID Reader with e-Pop-Loq, UHF Antenna, Trigger Handle, Battery, Battery Cover, no imager, red and black. AU |
| OR | IH21A0014 | FCC | IH21 Bluetooth RFID Reader with e-Pop-Loq, UHF Antenna, Trigger Handle, Battery, Battery Cover, no imager, red and black.FCC |
| OR | IH21A0002 | ETSI | IH21 Bluetooth RFID Rëader with e-Pop-Loq, UHF Antenna, Trigger Handle, Battery, Battery Cover, no imager, red and black.ETSI |
| 2 | IH21-EPL-CT40 | | Cover,ePop-Loq CT40, IH21 |
| 3 | IH21-CB-1 | | IH21 Docking Cradle with World traveler PSU and Mini USB Lead, red and black |
| OPTIONAL | IH21-QBC-1 | | 4-Slot Battery Charger. Order power supply 851-812-001 & Power Cord separately |
| OPTIONAL | 851-812-001 | | AC ADAPTER,12V/60W,2.5X5.5MM,LEVEL VI. Order AC Power Cord – See Page 38 for Country Specific Power Cords |
| OPTIONAL | 318-060-001 | | Spare Battery for IH21 RFID reader |

CT40 HEALTHCARE CHARGING AND COMMUNICATION

Option 1 - Non-Booted Quad Charger with Universal Cup

Chargebase – Quad Dock Charge Only
Netbase – Quad Dock with Ethernet
Not Compatible with CT40-RB-00 Rubber Boot or CT40-PB-00 / CT40-PB-XP Protective Boot

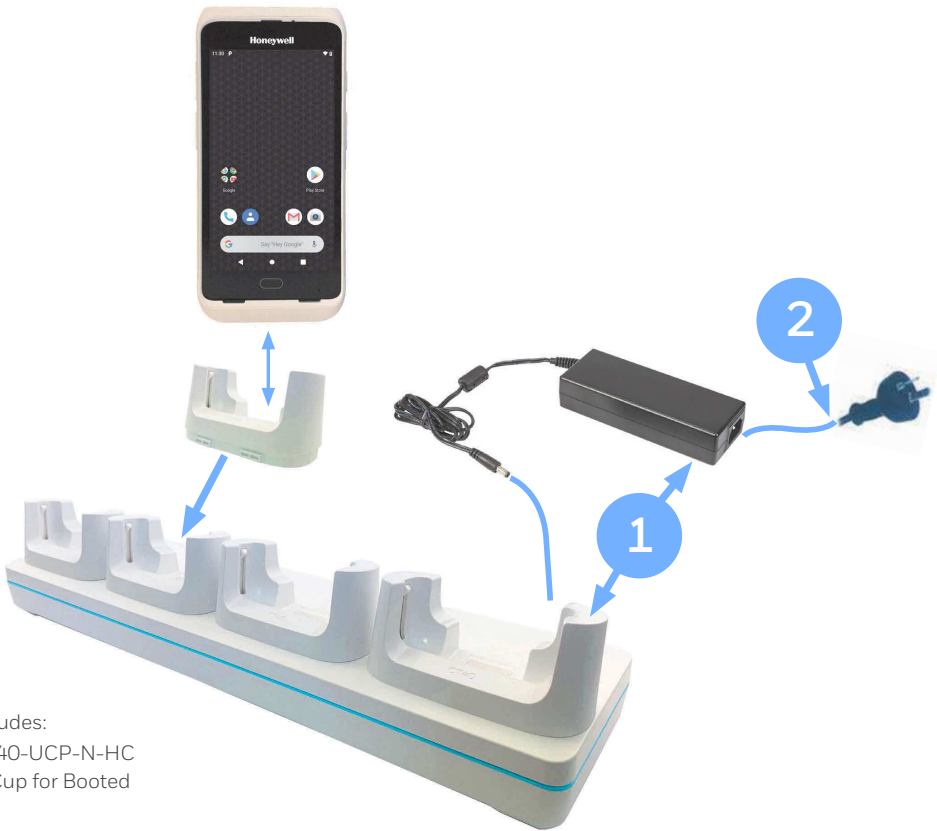

Kit Includes:
4 x CT40-UCP-N-HC
CT40 Cup for Booted

| | PART NUMBER | DESCRIPTION |
|----|-----------------|---|
| 1 | CT40-CB-UVN-HC0 | Non-Booted Chargebase with disinfectant ready housing. For recharging upto 4 computers without protective boot. Kit includes Dock, Power Supply,must order Power Cord separately. |
| OR | CT40-NB-UVN-HC0 | Non-Booted Net base with disinfectant ready housing, for Ethernet comms and recharging upto 4 computers without protective boot. Kit includes Dock and Power Supply, must order Power Cord separately. |
| 2 | ** | AC Power Cord – See Page 38 for Country Specific Power Cords |

Option 2 - Booted Quad Charger with Universal Cup

Chargebase – Quad Dock Charge Only
Netbase – Quad Dock with Ethernet
Compatible with CT40-PB-00 / CT40-PB-XP Protective Boot



Kit Includes:
4 x CT40-UCP-B-HC
CT40 Cup for Booted

| | PART NUMBER | DESCRIPTION |
|----|-----------------|--|
| 1 | CT40-CB-UVB-HC0 | Booted Chargebase with disinfectant ready housing. For recharging upto 4 computers with protective boot. Kit includes Dock, Power Supply,must order Power Cord separately. |
| OR | CT40-NB-UVB-HC0 | Booted Net base with disinfectant ready housing, for Ethernet comms and recharging upto 4 computers with protective boot. Kit includes Dock and Power Supply, must order Power Cord separately. |
| 2 | ** | AC Power Cord – See Page 38 for Country Specific Power Cords |

CT40 HEALTHCARE CHARGING AND COMMUNICATION

Option 3 - CT40 HC Display Base with Universal Cup

Connect USB peripherals (keyboard, mouse) and External Monitor via HDMI.



| PART NUMBER | DESCRIPTION |
|-------------|--|
| 1A | CT40-DB-UVN-HCO Non-Booted Display Dock with disinfectant ready housing - Kit includes (CT40-UCP-N-HC), Display Base & Power Supply, No Power Cord |
| 1B | CT40-DB-UVB-HCO Booted Display Dock with disinfectant ready housing - Kit includes (CT40-UCP-B-HC), Display Base & Power Supply, No Power Cord |
| 2 | ** AC Power Cord – See Page 38 for Country Specific Power Cords |

CT40 / CT40 XP PROTECTIVE BOOT

Option 1 - Rubber Boot

Use for added protection of the CT40.
Not Compatible with Scan Handles / Home Base / Charge Base Docks / Vehicle Dock.



1

| | PART NUMBER | DESCRIPTION |
|---|-------------|------------------|
| 1 | CT40-RB-00 | CT40 Rubber Boot |

Option 2 - Dockable Protective Boot

Use when protective boot is required with or without scan handle and dockable.



1

| | PART NUMBER | DESCRIPTION |
|----|-------------|---|
| 1 | CT40-PB-00 | CT40 TPU boot (Not Compatible with CT40 XP) |
| OR | CT40-PB-XP | CT40 protective boot to charge CT40XP & general CT40 configurations. A boot with the ability to expose the CT40XP 's Push To Talk (PTT) button. |

CT40 / CT40 XP HEADSET

CT40 Push To Talk (PTT) and VoIP Headset

BSR idware GmbH
Jakob-Haringer-Str.3
A-5020 Salzburg
<https://www.bsr.at>
sales@bsr.at

PTT and VoIP ready to support In-Store Communication with leading 3rd party applications.



| | PART NUMBER | DESCRIPTION |
|-------------------|----------------|---|
| 1 | CT40-HDST-35MM | CT40 Headset with PTT, 3.5mm audio jack |
| OPTIONAL 2 | CT40-CVT-25MM | 3.5mm plug to 2.5mm Socket Adaptor Cable (for attaching 3rd party 2.5mm headsets) |

CT40 / CT40 XP WEARABLE

CT40 with Tethered Ring Scanner

Convert the CT40 into a Wearable Computer with Tethered Ring Scanner.



CT40 / CT40 XP WEARABLE WITH TETHERED RING SCANNER

Option 1 - CT40 Wearable with D75e Arm Band

Re-use existing D75e Arm Band (HWC-ARM BAND).



| PART NUMBER | DESCRIPTION |
|--------------|---|
| CT40-WS-KIT | CT40 WEARABLE SET, including Holder, tethered ring scanner and arm band |
| CT40-WS-PB | CT40 Holder with tethered ring scanner |
| HWC-ARM BAND | Arm Band, Wearable Computer |

Option 2 - CT40 Wearable - Arm Band Wrist Pad

Arm Band with wrist pad.



| PART NUMBER | DESCRIPTION |
|-------------|--|
| CT40-WS-00 | CT40 WEARABLE SET, including Holder, tethered ring scanner and arm band. |
| CT40-WS-PB | CT40 Holder with tethered ring scanner |
| CT40-WS-AB | Arm Band Wrist Band |

See next page for exploded view of individual components.

CT40 / CT40 XP WEARABLE WITH TETHERED RING SCANNER

Option 1 - CT40 Wearable with D75e Arm Band

Re-use existing D75e Arm Band (HWC-ARM BAND).



| | PART NUMBER | DESCRIPTION |
|---|-------------|---|
| 1 | CT40-PB-XP | CT40 protective boot to charge CT40XP & general CT40 configurations. |
| 2 | CT40-WS-KIT | CT40 WEARABLE SET, including Holder, tethered ring scanner and arm band. CT40-WS-PB CT40 Holder with tethered ring scanner HWC-ARM BAND Arm Band, Wearable Computer |

Honeywell Repair Services

Option 2 - CT40 Wearable - Arm Band Wrist Pad

Arm Band with wrist pad.



| | PART NUMBER | DESCRIPTION |
|---|-------------|---|
| 1 | CT40-PB-XP | CT40 protective boot to charge CT40XP & general CT40 configurations. |
| 2 | CT40-WS-00 | CT40 WEARABLE SET, including Holder, tethered ring scanner and arm band. CT40-WS-PB CT40 Holder with tethered ring scanner CT40-WS-AB Arm Band Wrist Band |

Honeywell Repair Services

MISCELLANEOUS

Optional Parts

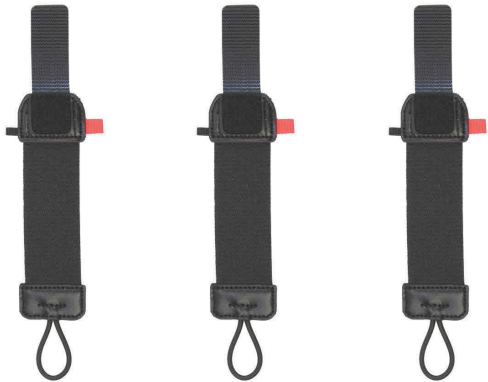

| PART NUMBER | DESCRIPTION |
|-------------|----------------------------|
| CT40-HS-3PK | CT40 HAND STRAP, pack of 3 |



| PART NUMBER | DESCRIPTION |
|-------------|---|
| CT40-HS-HC | CT40 Healthcare HAND STRAP, 3PCS / PACK |



| PART NUMBER | DESCRIPTION |
|----------------|---|
| 213-048-001 | Pack of 5 CT40 / CT50 / CT60 replacement styluses. |
| 8754-871600-20 | Pack of 10 CT40 / CT50 / CT60 replacement styluses. |



| PART NUMBER | DESCRIPTION |
|--------------|---|
| CT40-SP-10PK | Contains 10 self-adhesive screen protectors |



| PART NUMBER | DESCRIPTION |
|--------------|--|
| 50121666-001 | Power Adapter, 12V 3A, No Power Cord, Compatible with CT40 Homebase / eHomebase / Quad Battery Charger |



| PART NUMBER | DESCRIPTION |
|--------------|---|
| 50121667-001 | Power Adapter, 12V 7A, No Power Cord, CT40 Quad Chargebase/Quad Netbase |

MISCELLANEOUS

Optional Parts



| PART NUMBER | DESCRIPTION |
|-------------|---|
| CT40-UCP-N | CT40 Non-Booted universal cup, to be used for CT40 without protective boot |



| PART NUMBER | DESCRIPTION |
|-------------|---|
| CT40-UCP-B | CT40 Booted universal cup, to be used for CT40 with protective boot (CT40-PB-XP) |

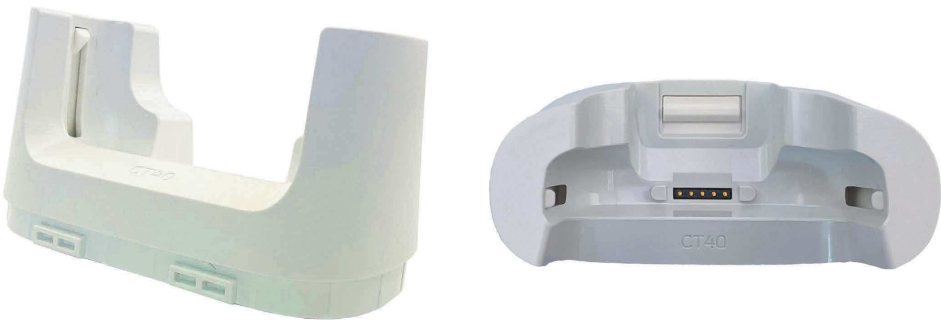

| PART NUMBER | DESCRIPTION |
|---------------|--|
| CT40-UCP-N-HC | CT40 Non-Booted disinfectant ready housing universal cup, to be used for CT40 without protective boot |



| PART NUMBER | DESCRIPTION |
|---------------|--|
| CT40-UCP-B-HC | CT40 Booted disinfectant ready housing universal cup, to be used for CT40 with protective boot (CT40-PB-XP) |

MISCELLANEOUS

Optional Parts



| PART NUMBER | DESCRIPTION |
|-------------|---|
| CT50-CC-12 | CHARGING CABINET FOR CT40/CT50/CT60 with space to house 12 Computers and 12 Spare Batteries. Quad battery chargers (CT40-QBC-0) and Quad ChargeBase (CT40-CB-0) |



| PART NUMBER | DESCRIPTION |
|-------------|---|
| CT40-QL-00 | CT40 Quad Lock Case Mount CT40 to 3rd party RFID readers |



| PART NUMBER | DESCRIPTION |
|-------------|-------------------------------|
| 825-237-001 | POUCH, CT40/CT50/CT60/CT60 XP |



| PART NUMBER | DESCRIPTION |
|-------------|--------------------------------|
| 825-238-001 | CT40/CT50/CT60/CT60 XP Holster |

MISCELLANEOUS

Micro-SD Cards

Honeywell Recommended – ATP Industrial Grade Micro SD Cards

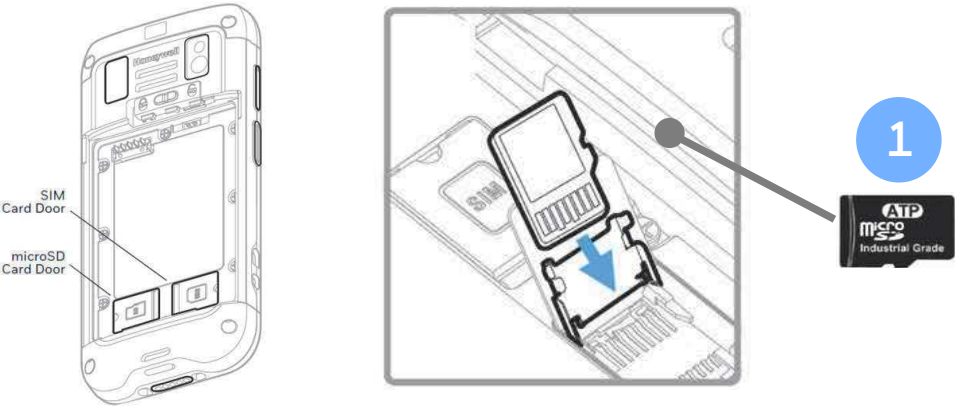

Why ATP Industrial Grade SD?

ATP's SIP (System-In-Packaging) manufacturing process encapsulates all exposed components and points of failure to ensure the products are fully waterproof, shockproof, and ESD (Electro-Static Discharge) proof. ATP Industrial Grade SD/SDHC Cards can withstand at least an operating/storage temperature range of at least -40 to 85 degrees Celsius. In addition to this temperature range, the cards are completely waterproof, dustproof, and ESD (Electro-Static Discharge) proof. All ATP Industrial Grade SD/SDHC cards are produced under a stringent RoHs and Green Package compliant manufacturing process to guarantee a consistent high level of build quality and performance. ATP Industrial SD cards deliver outstanding performance with read speed (seq) up to 18MB/sec and write speed (seq) up to 16MB/sec. All ATP Industrial Grade CF, SD, USB drives, and SSDs are constructed using best-in-class SLC(Single-Level Cell) components with enhanced Error Correction Code(ECC) functions and wear levelling algorithms. This results in MTBF ratings over 2 million hours and the highest write cycle lifetimes in the industry.

| | PART NUMBER | DESCRIPTION |
|----|-------------|-----------------------------------|
| 1 | 856-065-004 | MICRO-SD CARD, 1GB, AF1GUDI, ROHS |
| OR | 856-065-005 | MICRO-SD CARD, 2GB, AF1GUDI, ROHS |
| OR | 856-065-006 | MICRO-SD CARD, 4GB, AF1GUDI, ROHS |
| OR | 856-065-007 | MICRO-SD CARD, 8GB, AF1GUDI, ROHS |

AC Cords

Regional Power Cords



AC Power – C13 Type Connector

| PART NUMBER | DESCRIPTION |
|--------------|---|
| 50117501-001 | POWER CORD AUSTRALIA 2500MM,SLED CB |
| 321-501-002 | AC Power Cord, Denmark RoHS |
| 77900508E | Cable: power cord, power supply to AC outlet, straight, Power cord, Europe EU, IEC320-C13, 2.5 m (8.2 ft) |
| 321-502-002 | AC Power Cord, India/S Africa RoHS |
| 321-500-002 | AC Power Cord, Japan RoHS |
| 9000093CABLE | AC POWER CABLE, C14 TYPE, SWITZERLAND 3-PIN |
| 77900507E | Cable: power cord, power supply to AC outlet, straight - Power cord, UK, IEC320-C13, 2.5 m (8.2 ft) |
| 1-974028-025 | AC Power Cord, US RoHS |

MISCELLANEOUS

Disclaimer

Honeywell International Inc. ("HII") reserves the right to make changes in specification and other information contained in this document without prior notice, and the reader should in all cases consult HII to determine whether any such changes have been made. The information in this publication does not represent a commitment on the part of HII.

HII shall not be liable for technical or editorial errors or omissions contained herein; nor for incidental or consequential damages resulting the furnishing, performance, or use of this material.

This document contains proprietary information that is protected by copyright. All rights are reserved. No part of this document may be photocopied, reproduced, or translated into another language with-out prior written consent of HII.

Web Address: www.honeywellaidc.com

The Bluetooth trademarks are owned by Bluetooth SIG, Inc., U.S.A and licensed to Honeywell.

Thor and Mobility Edge are trademarks or registered trademarks of Honeywell International Inc. in the United States and/or other countries.

Android is a trademark or registered trademark of Google Inc. in the United States and/or other countries. Windows is a trademark or registered trademark of Microsoft Corporation.

Qualcomm and Snapdragon are trademarks or registered trademarks of Qualcomm Incorporated in the United States and/or other countries.

Other product names mentioned in the manual may be trademarks of registered trademarks of their respective companies and are the property of their respective owners.

All rights reserved.

For more information

www.honeywellaidc.com

Honeywell Safety and Productivity Solutions

9680 Old Bailles Road

Fort Mill, SC 29707

800-582-4263

www.honeywell.com

CT40 / CT40 XP Configuration Guide - GLOBAL | Rev F | 07/20
© 2020 Honeywell International Inc.



BSR idware GmbH

Jakob-Haringer-Str.3

A-5020 Salzburg

<https://www.bsr.at>

sales@bsr.at

THE
FUTURE
IS
WHAT
WE
MAKE IT

Honeywell