

ALGIZ RT10

QUICK START GUIDE



BSR idware GmbH

Jakob-Haringer-Str.3

A-5020 Salzburg

<https://www.bsr.at>

sales@bsr.at



handheld

① WHAT'S IN THE BOX

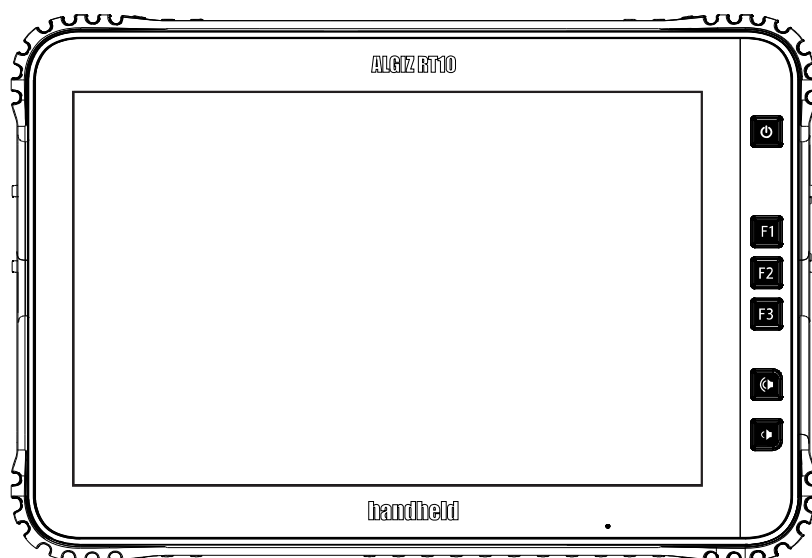

ALGIZ R10 Main body

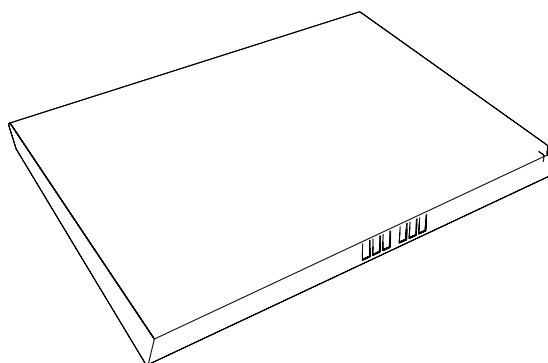

Standard battery

② YOUR ALGIZ RT10

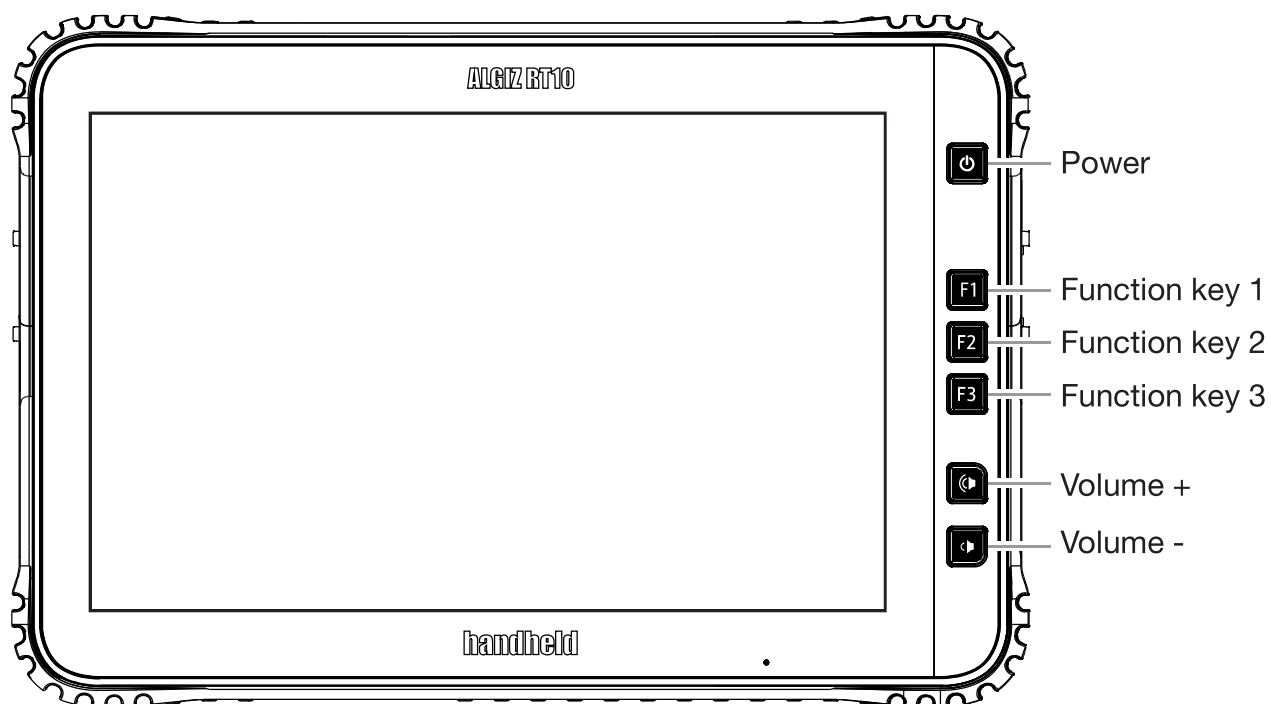

③ YOUR ALGIZ RT10

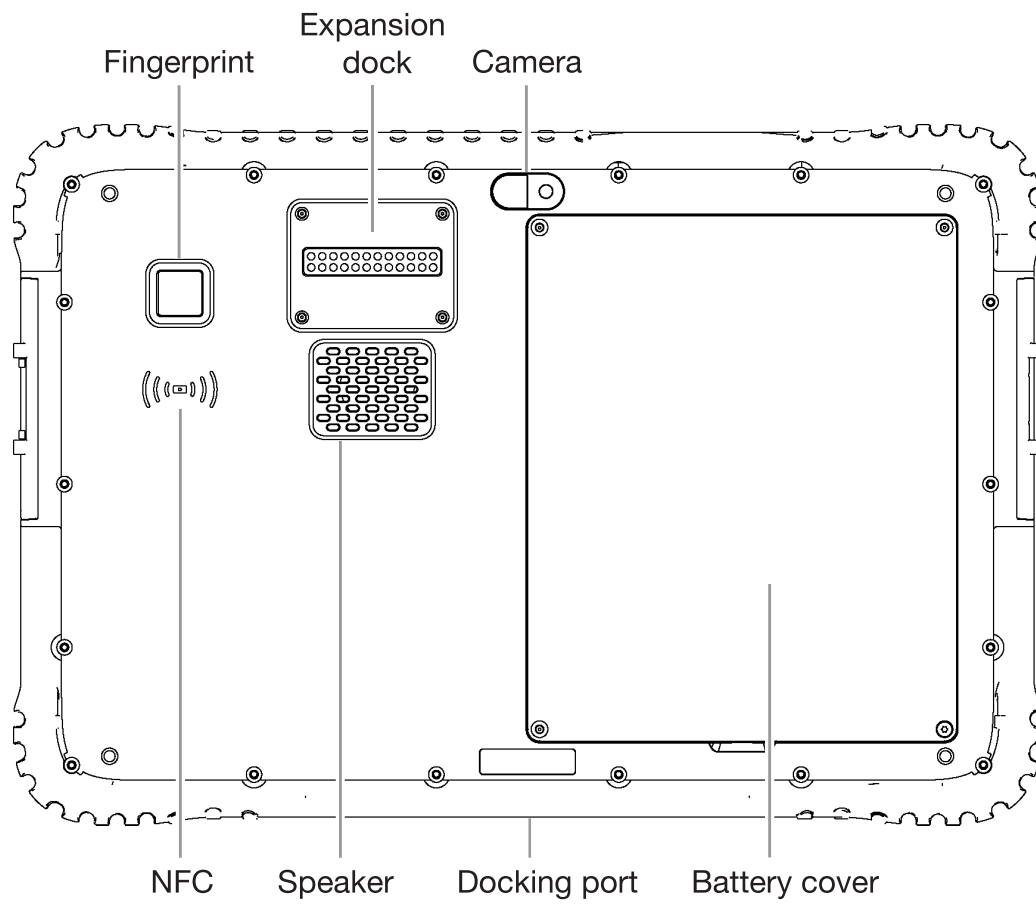

④ SIM/MICRO SD CARD

This is how you insert and remove the Nano SIM/micro SD.

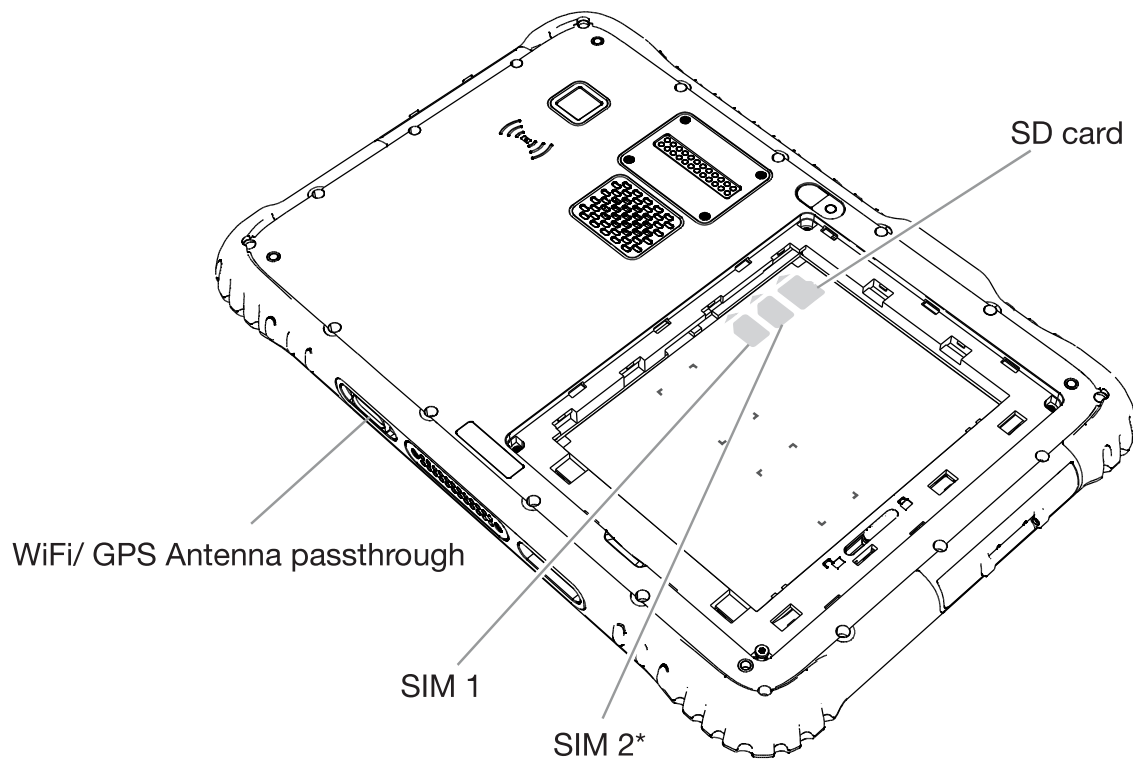

* SIM 2 only available on RT10-RF1-AXX models

⑤ INSERT BATTERY

To insert the battery

1. Insert the battery
2. Push the battery lock to the close position
3. Attach the battery cover
4. Insert and tighten battery cover screws

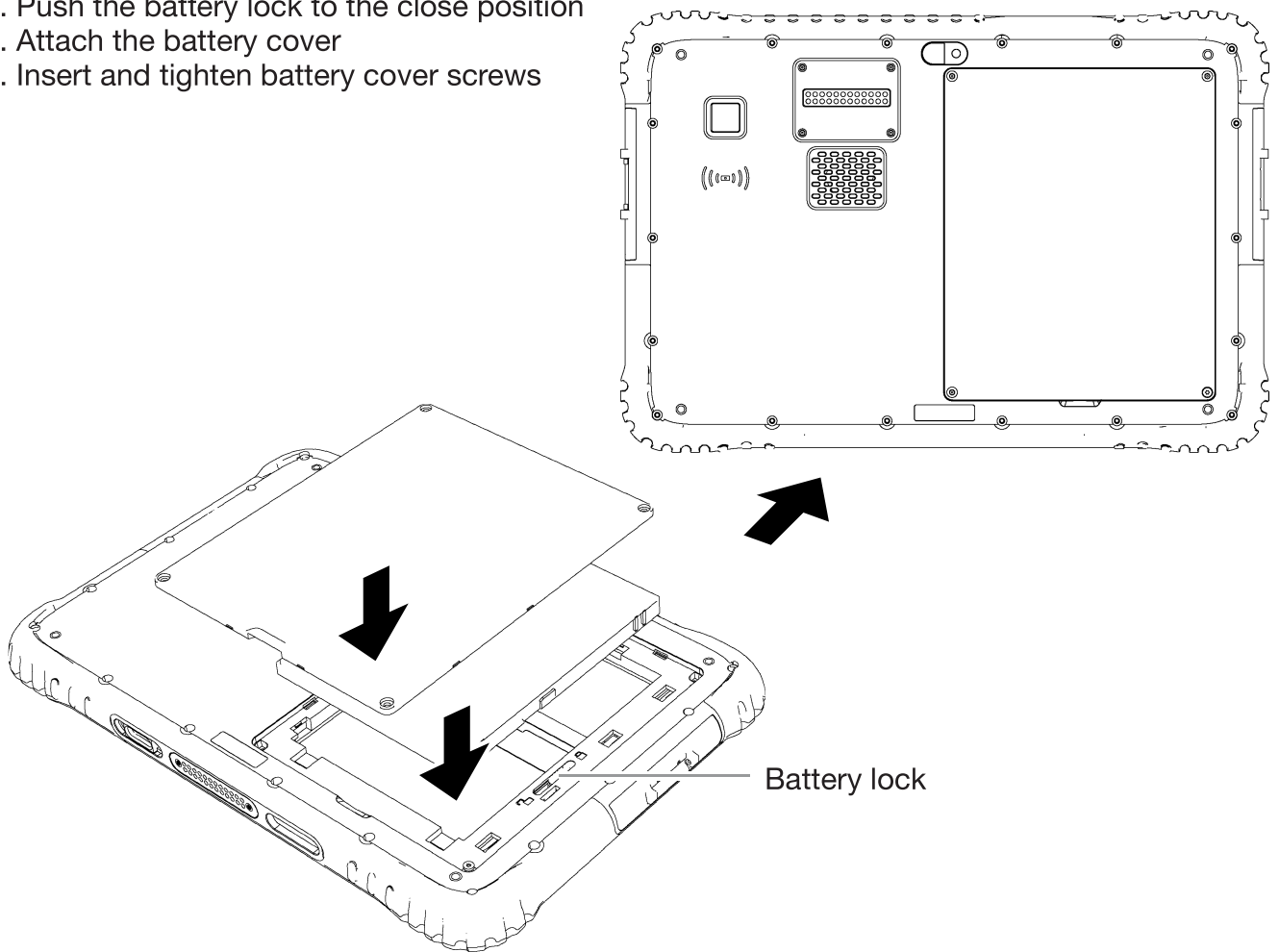

⑥ REMOVE BATTERY

To remove the battery

1. Power off the device before removing the battery
2. Remove battery cover screws
3. Detach the battery cover
4. Push the battery lock to the open position
5. Remove the battery

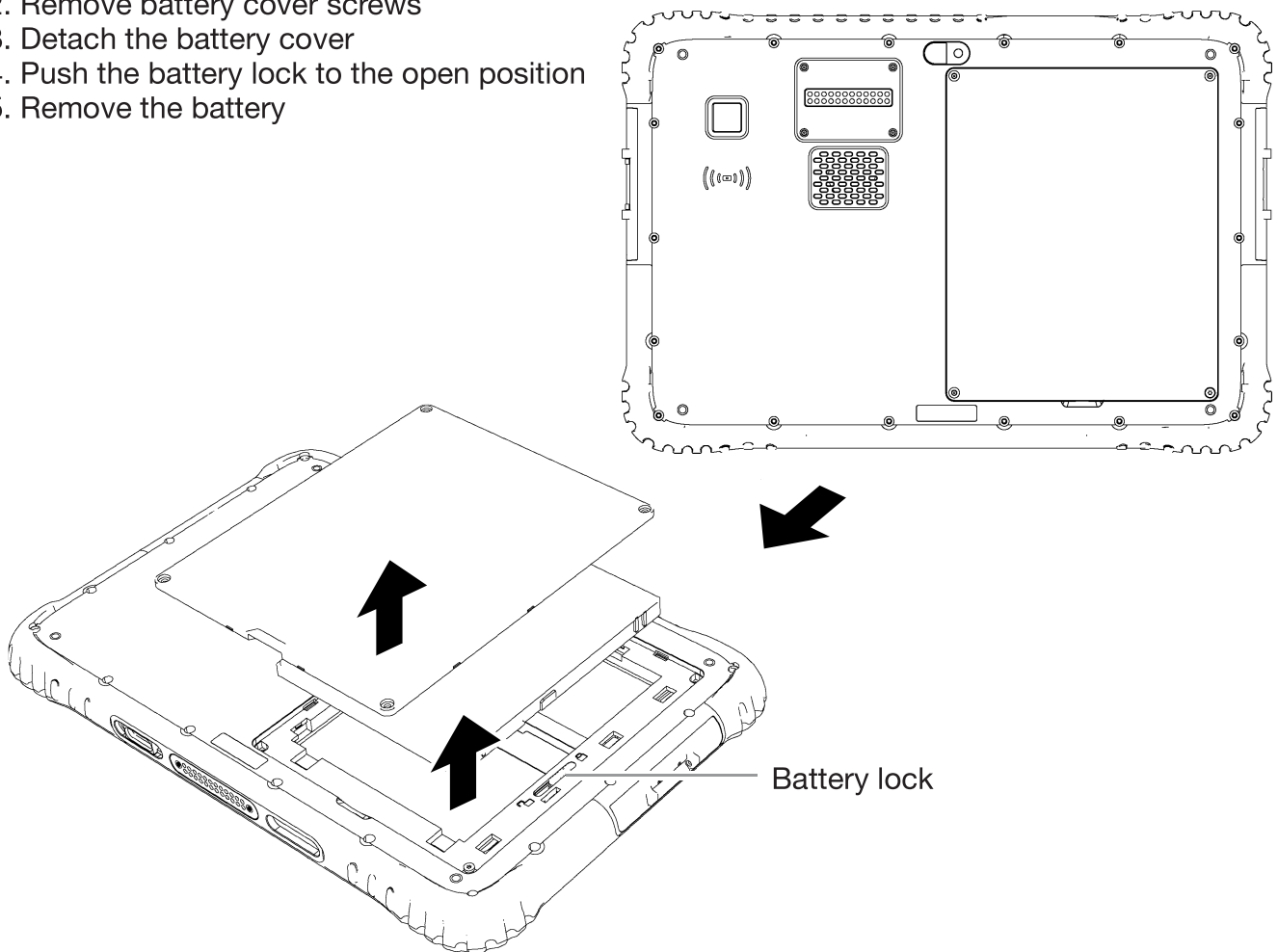

Please go to www.handheldgroup.com/knowledgebase to download more information.



BSR idware GmbH

Jakob-Haringer-Str.3

A-5020 Salzburg

<https://www.bsr.at>

sales@bsr.at

Version 1.1

handheld

www.handheldgroup.com